

## MUDROOM LOCKER CABINETS

### MATERIALS *(affiliate links)*:

- (1) [4' x 8' sheets of ¼-inch PureBond® walnut hardwood plywood](#)
- (5) [4' x 8' sheets of ¾-inch PureBond® walnut hardwood plywood](#)
- (3) [Drawer boxes @ 16" wide x 21" deep x 10" tall](#)
- 1x3x8 boards
- 1x2x8 boards
- Wood glue

### HARDWARE:

- (3) [21-inch undermount full-extension soft-close drawer slides](#)
- (3) [Drawer pulls](#)
- (3) [Locker door pulls](#)
- (3) [Pull Backplates](#)
- (3) [Cabinet latches](#)
- (9) [Pairs of soft-close inset hinges for frameless cabinets](#)
- (6) [Cabinet magnetic door stops](#)
- 1 ¼-inch Pocket Screws
- Brad nails
- Pin nails
- (3) [Sheets of Brass Mesh](#) (optional)
- (12) [Shelf Pins](#) (optional)

### ORGANIZATION:

- [Coat hooks](#)
- [Sunglasses organizer](#)
- [Boot trays](#)
- [Wicker baskets](#)

**Jen's note:** *I know this seems like a lot of tools – many of them are marked with an asterisk to denote that they are not necessary but “nice-to-haves.” And if you’re not milling your own lumber, you won’t need a jointer or thickness planer.*

### TOOLS:

- [Tape Measure](#)
- [Cordless Drill/Driver](#)
- [Carpenter’s Square](#)
- [SawStop Professional Cabinet Saw with T-Glide Advance Fence](#)
- [SawStop Revolution Miter Gauge](#)
- [SawStop Combination Saw Blade](#)
- [Table Saw Push Blocks](#)

- [Pocket Hole Jig](#)
- [Concealed Hinge Jig](#)
- [Compound Miter Saw](#)
- [Brad Nailer](#)
- [Pin Nailer](#)
- [Orbital Sander](#)
- [Parallel Bar Clamps](#)
- [Safety Glasses](#), [Dust Mask](#), [Hearing Protection](#)
- \*[SawStop Premium Dado Set with Zero Clearance Dado Stack Insert](#)
- \*[Featherboards](#)
- \*[Thin Rip Jig](#)
- \*[Setup Blocks Height Gauge Set](#)
- \*[Multi-mark Layout Tool](#)
- \*[Shelf Pin Jig](#)
- \*[Double-Sided Woodworking Tape](#)
- \*[13" Thickness Planer](#)
- \*[Plunge-Cut Track Saw](#)
- \*[Router Table](#)
- \*[Bead Router Bit](#)
- [Rubio Monocoat Oil Plus 2C](#) (*my favorite wood finish!*)

#### **ADDITIONAL RESOURCES**

- [YouTube](#)
- [Blog](#)

#### **CUT LIST**

**\*\*All grooves are 1/4" wide and 3/8" deep. All tenons are 3/8" long.**

#### **Drawers**

- (2) 2x4 @ 54" – base frame
- (4) 2x4 @ 17" – base frame
- (2) 3/4" plywood @ 24" x 54" – top and bottom panels
- (6) 3/4" plywood @ 24" x 12 1/8" – side panels
- (3) solid walnut boards @ 16 3/8" x 12" – drawer face
- (1) 1x2 @ 52 1/2" – face frame (bottom rail)
- (2) 1x2 @ 13 5/8" – face frame (end stiles)
- (2) 1x2 @ 12 1/8" – face frame (middle stiles)

#### **Lockers**

- (6) 3/4" plywood @ 24" x 71 1/4" – side panels
- (6) 3/4" plywood @ 24" x 18" – top and bottom panels
- (3) plywood @ 18" x 72 3/4" – back panels (can be 1/4", 1/2", or 3/4" plywood, your choice)

- (6) 1x3 ripped to 2 ¼” wide @ 71 1/8” – locker door stiles
- (9) 1x3 ripped to 2 ¼” wide @ 12 5/8” – locker door rails
- (6) ¼” plywood @ 12 5/8” x 33” – locker door panels
- (3) ¾” plywood @ 16 ½” x 20” – locker shelves (optional)

### **Upper Cabinets**

- (2) ¾” plywood @ 24” x 54” – top and bottom panels
- (6) ¾” plywood @ 24” x 12 ½” – side panels
- (3) plywood @ 18” x 14” – back panels (can be ¼”, ½”, or ¾” plywood, your choice)
- (6) 1x3 ripped to 2 ¼” wide @ 12 3/8” – cabinet door stiles
- (6) 1x3 ripped to 2 ¼” wide @ 12 5/8” – cabinet door rails
- (3) ¼” plywood @ 12 5/8” x 8 5/8” – cabinet door panels

### **Face Frame for Lockers and Upper Cabinets**

- (2) 1x2 @ 88 ¼” – end stiles
- (2) 1x2 @ 85 3/16” – middle stiles
- (2) 1x2 @ 52 ½” – top and bottom rails
- (3) 1x2 @ 16 ½” – middle rails

PLYWOOD CUT LAYOUT









**BUILD THE LOCKER CARCASS**

Measure, mark, and cut 3/4-inch plywood to size. Drill pocket holes into the ends of the side panels and attach the side panels to the top and bottom panels as shown with 1 1/4-inch pocket screws and wood glue. Check for square and adjust accordingly.

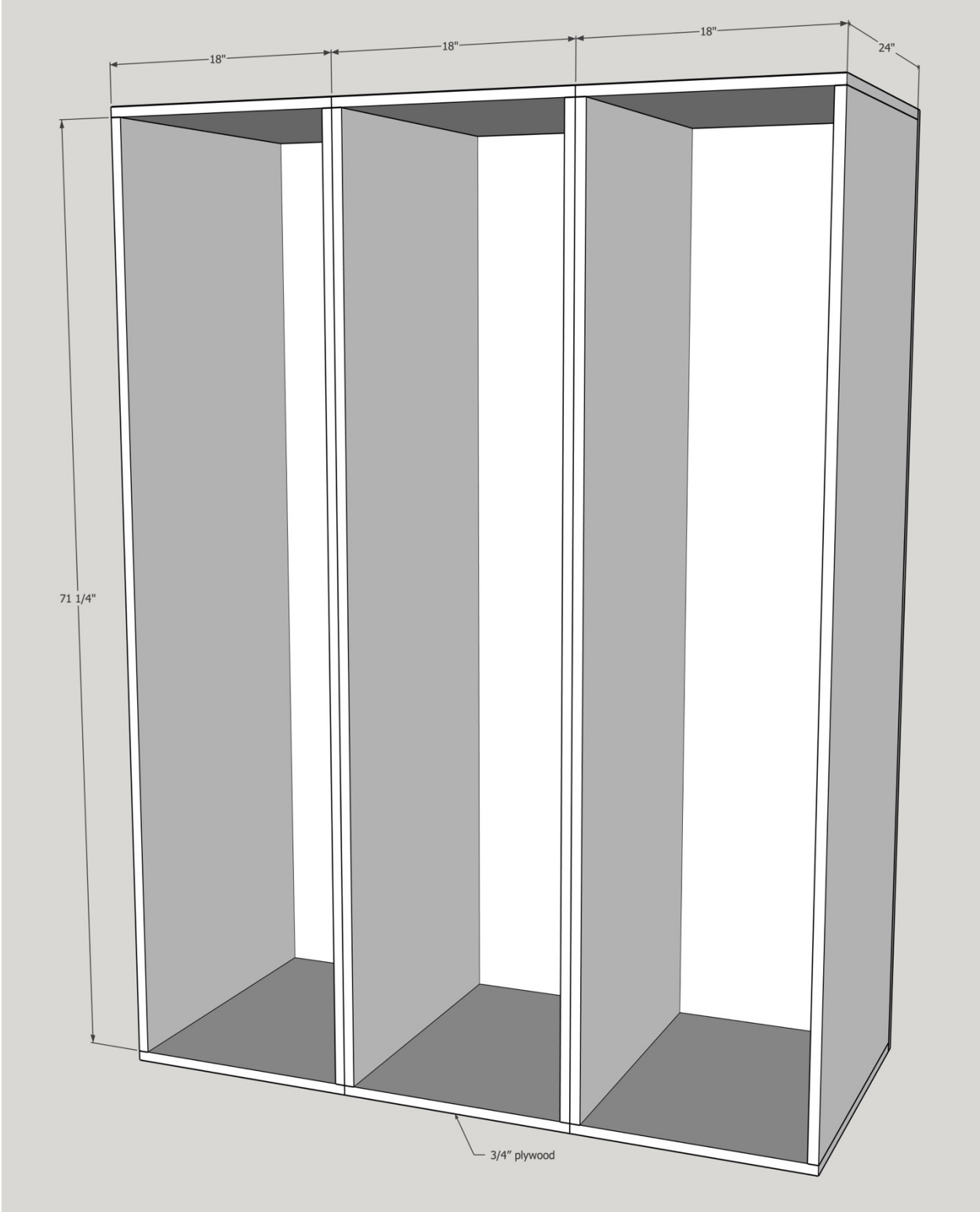

Attach the back panel to the locker carcass. The back panel can be ¼-, ½-, or ¾-inch plywood – your choice!

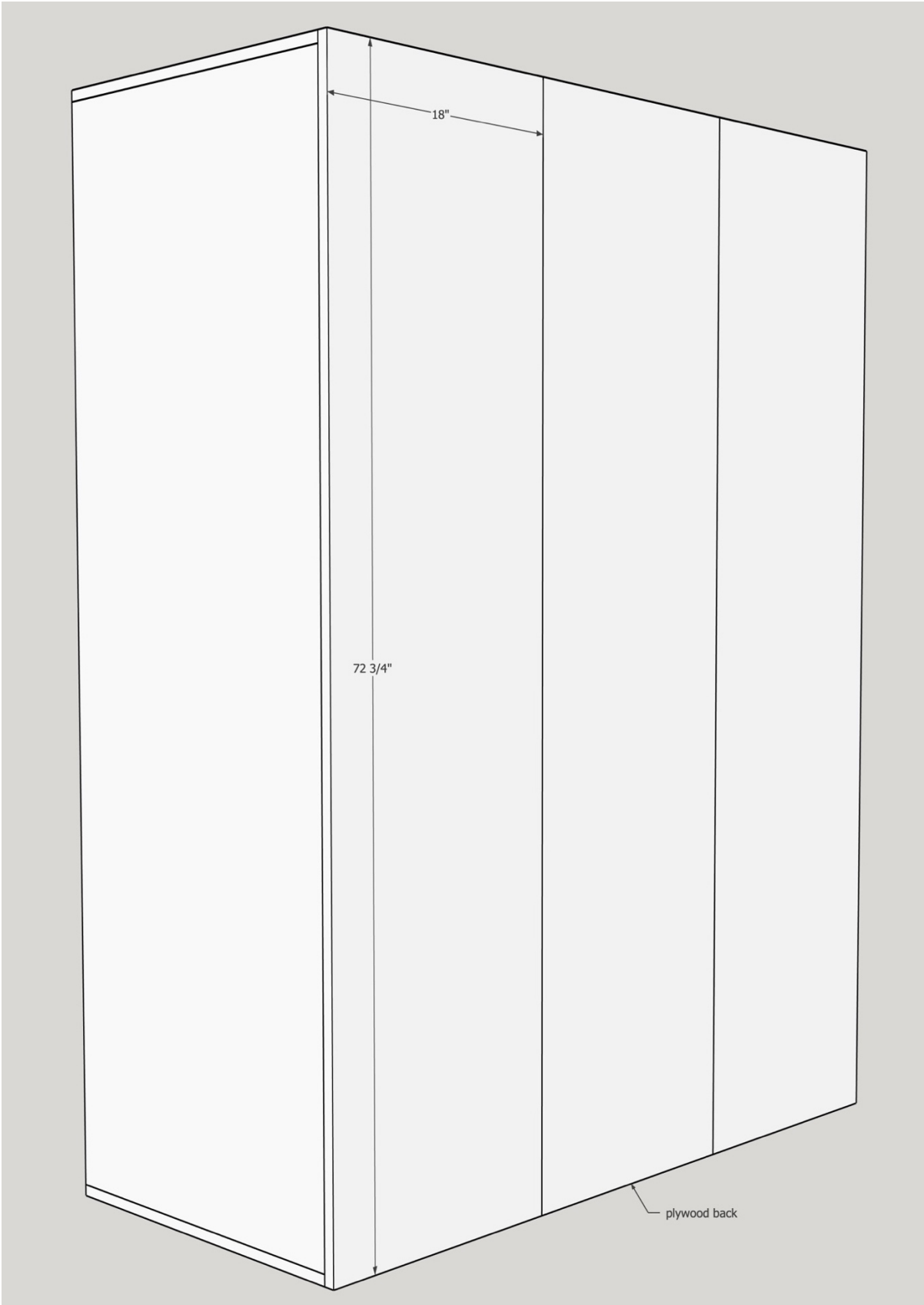

## **BUILD THE BASE FRAME AND DRAWER CARCASS**

**\*Jen's note:** *Your space may not need a base frame. If not, skip this step.*

Build the 2x4 base frame if needed. Measure, mark, and cut 2x4 boards to length and construct the base frame as shown.

Measure, mark, and cut ¾-inch plywood to size. Drill pocket holes into the ends of the side panels and attach to the top and bottom panels with 1 ¼-inch pocket screws and wood glue. Check for square and adjust accordingly.

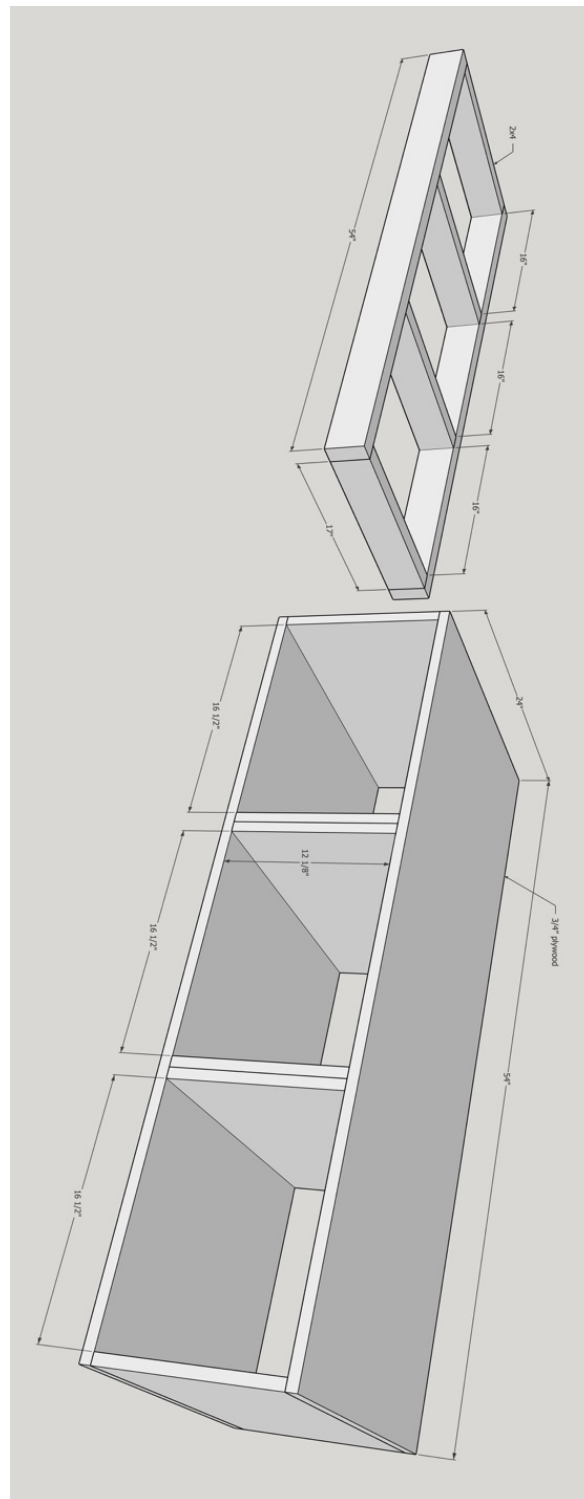

**\*Jen's note:** I ordered my dovetailed drawer boxes online and was able to customize the wood species, size, and finish.

Install the drawer slides according to the manufacturer's directions, then install the drawer boxes.

## MAKE THE DRAWER FRONTS

*\*Jen's note: You can use 3/4-inch plywood with edge banding veneer for the drawer fronts if you'd prefer. I used solid wood for my drawer fronts and had to glue boards together to make them tall enough.*

Measure, mark, and cut the drawer front to size. Attach it to the front of the drawer box, then install the drawer pull.

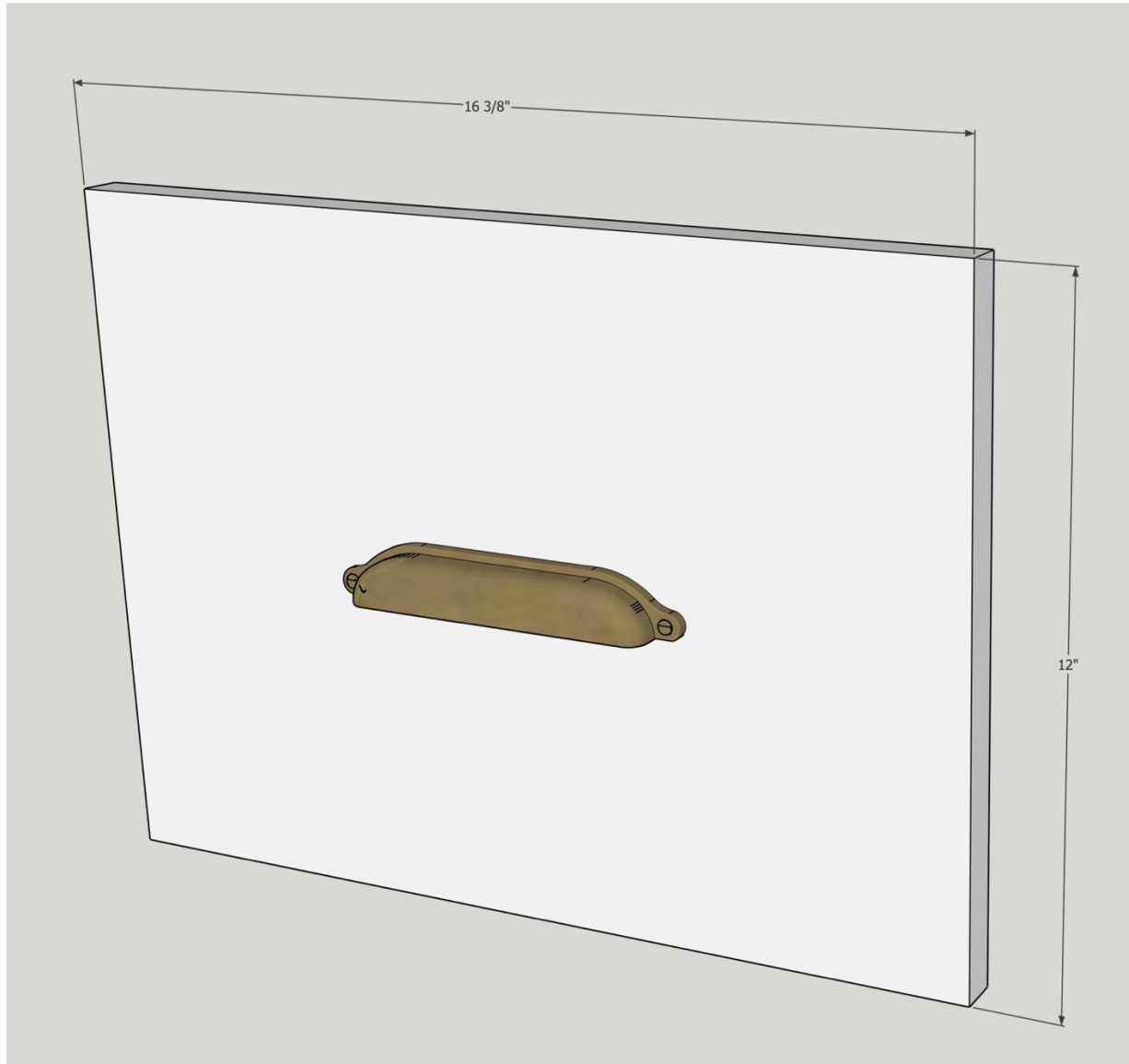

**BUILD THE UPPER CABINET CARCASS**

Measure, mark, and cut 3/4-inch plywood to size. Drill pocket holes into the ends of the side panels and attach them to the top and bottom panels as shown. Check for square and adjust accordingly.

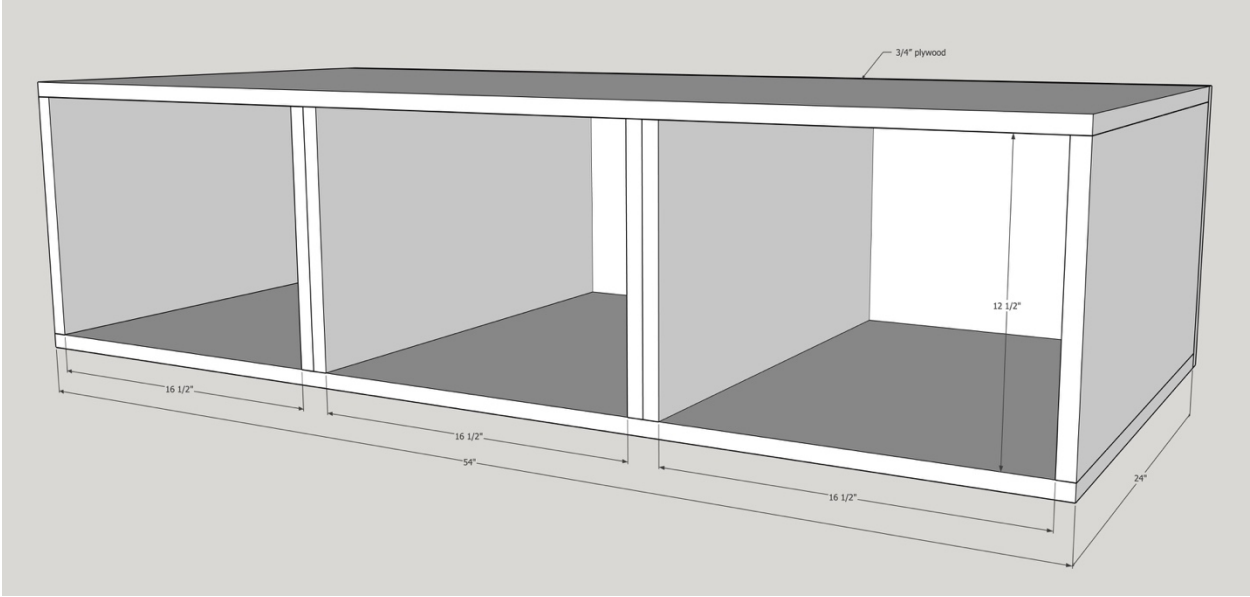

Attach the back panel to the upper cabinet carcass. The back panel can be 1/4-, 1/2-, or 3/4-inch plywood – your choice!

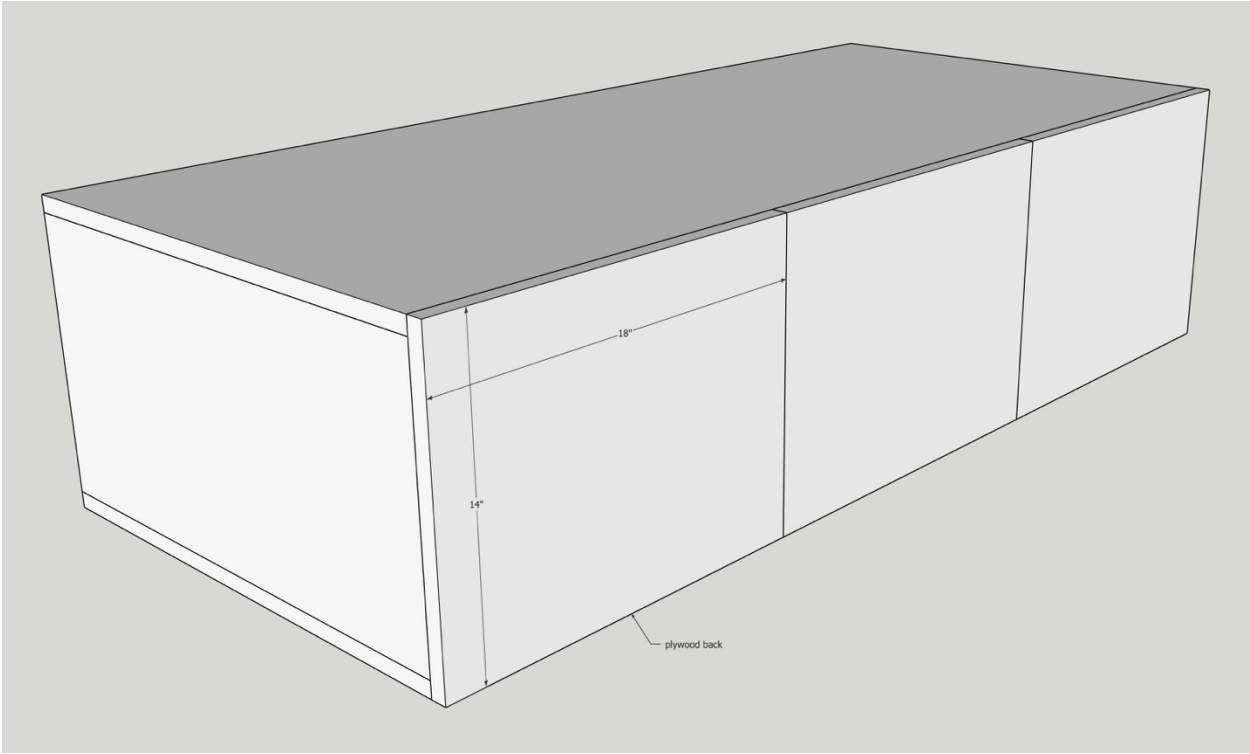

Dry-fit then install carcasses into your space, screwing the carcasses to the wall studs.

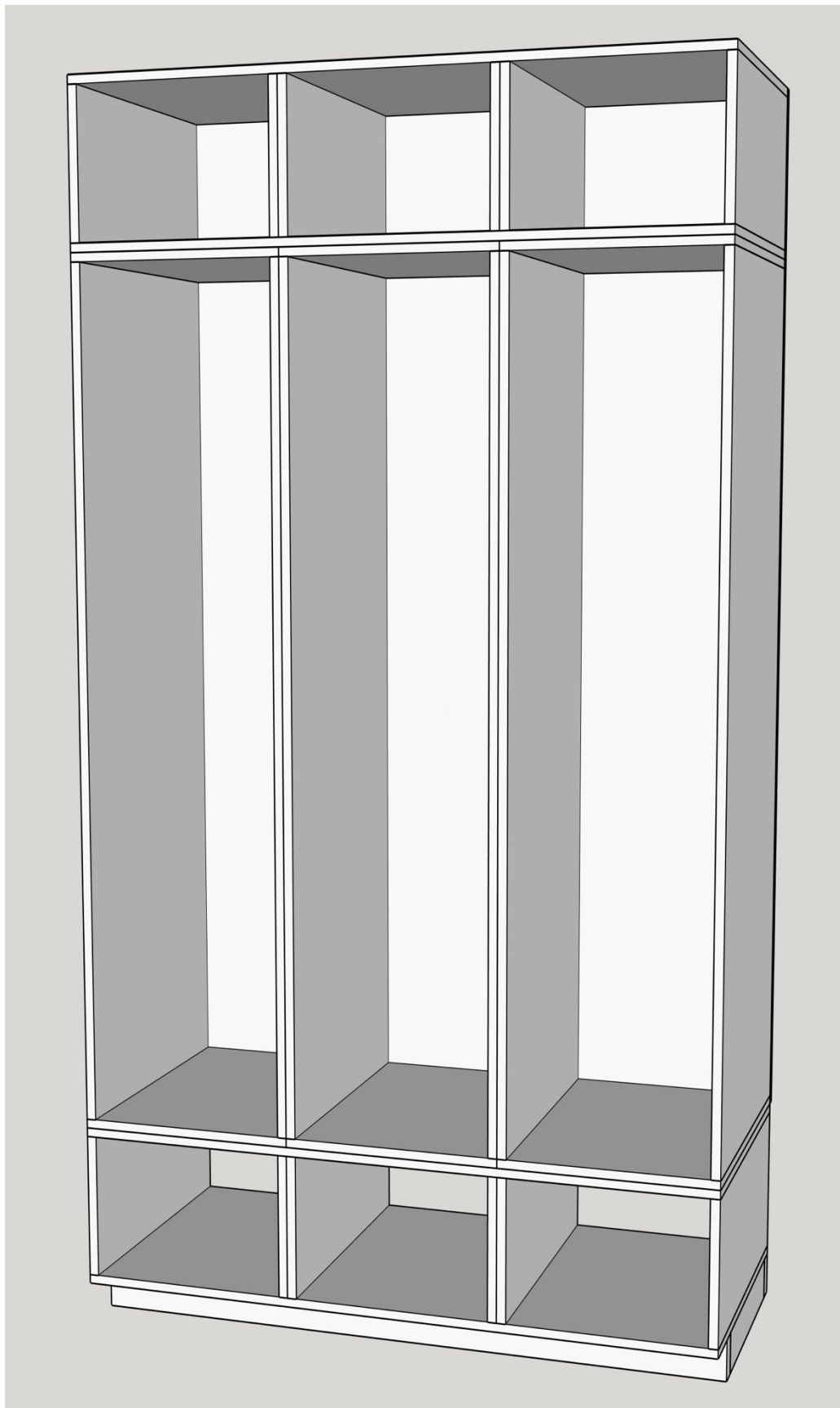

**BUILD THE FACE FRAME**

Measure, mark, and cut 1x2 boards to length. Drill pocket holes into the ends of the rails and stiles and construct the face frame as shown. Check for square and adjust accordingly.



### **BUILD THE LOCKER DOOR**

All door rails and stiles are 2 ¼” wide. Rip 1x3 boards to 2 ¼” wide. Measure, mark, and cut stiles to length. Cut a groove on one edge of the stiles. The groove should be ¼” wide x 3/8” deep. Measure, mark, and cut rails to length. Cut a groove on one edge of the top and bottom rails and cut a groove on both edges of the middle rail. Cut 3/8-inch long tenons on both ends of the rails.

***\*Jen’s note:** Use quarter-sawn boards for the long stiles of the locker doors if possible – quarter-sawn lumber is more stable than plain- or flat-sawn. Installing the dado set on your table saw will make cutting tenons more efficient and precise.*

Measure, mark, and cut ¼-inch plywood to size. These panels should slide into the grooves easily.

### **ASSEMBLE THE LOCKER DOOR**

Apply glue to the tenons and assemble three sides of the door. Slide the ¼-inch panel into the groove, then add the last rail. Check for square, adjust, clamp, and glue. The ¼-inch panels should float inside the grooves in the rails and stiles to allow for seasonal wood movement.

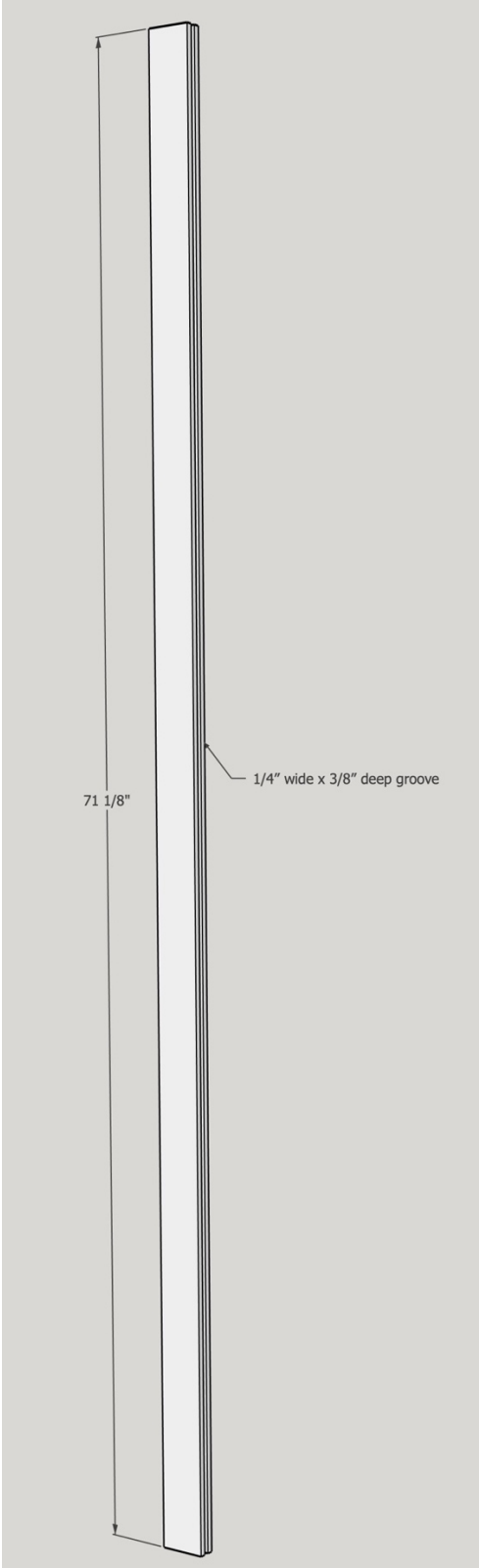
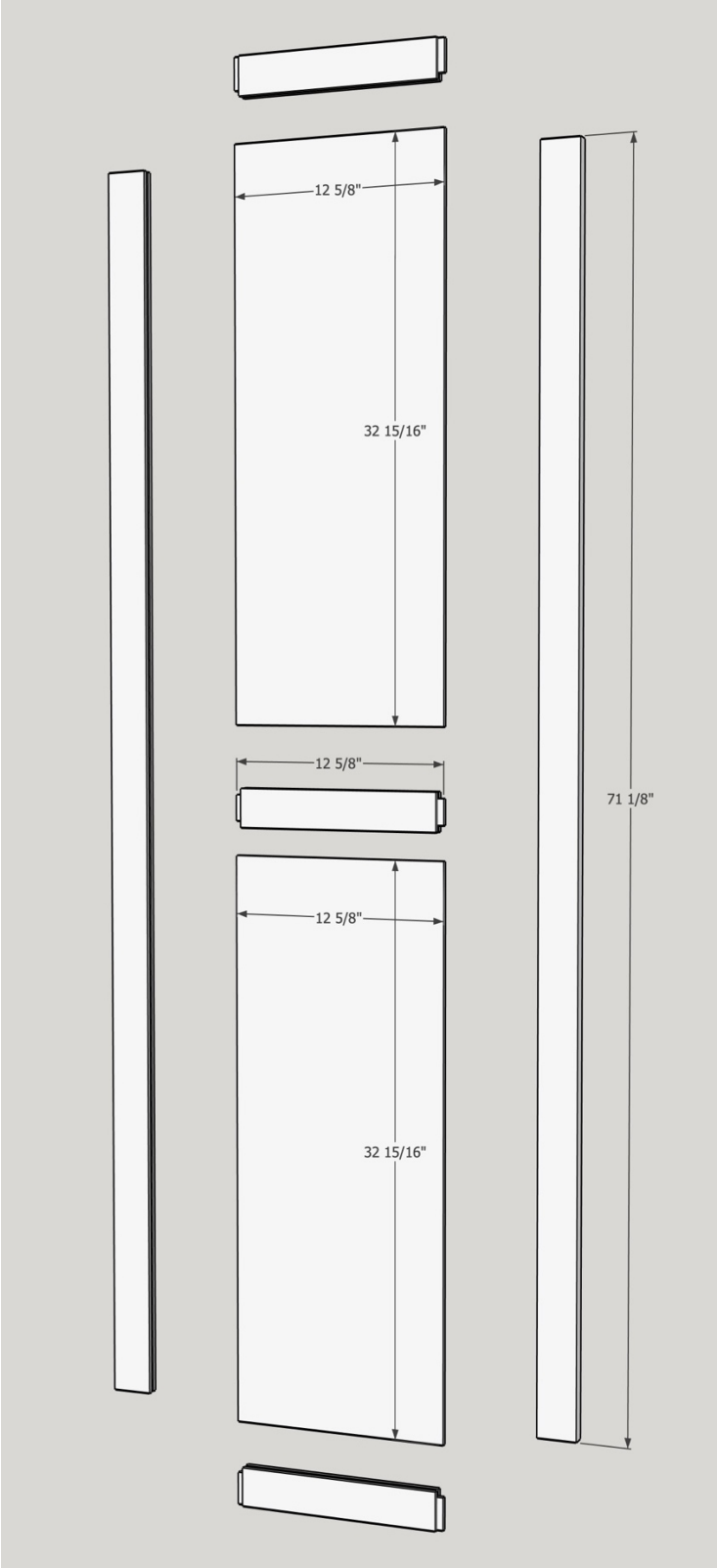

Locker Door Top and Bottom Rails (image below)

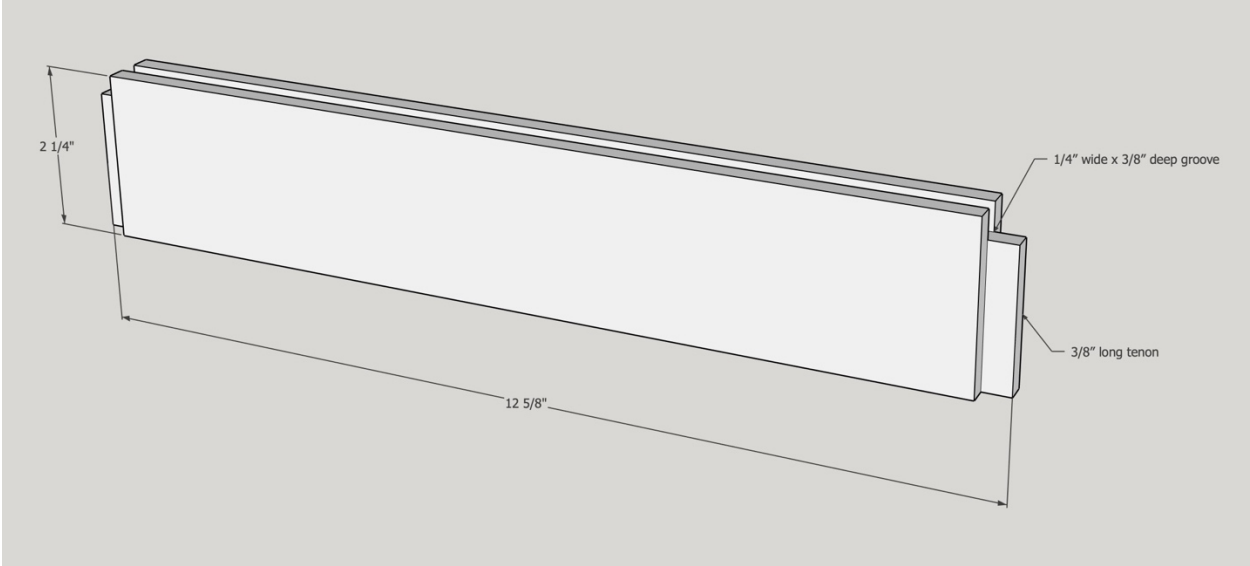

Locker Door Middle Rails (image below)

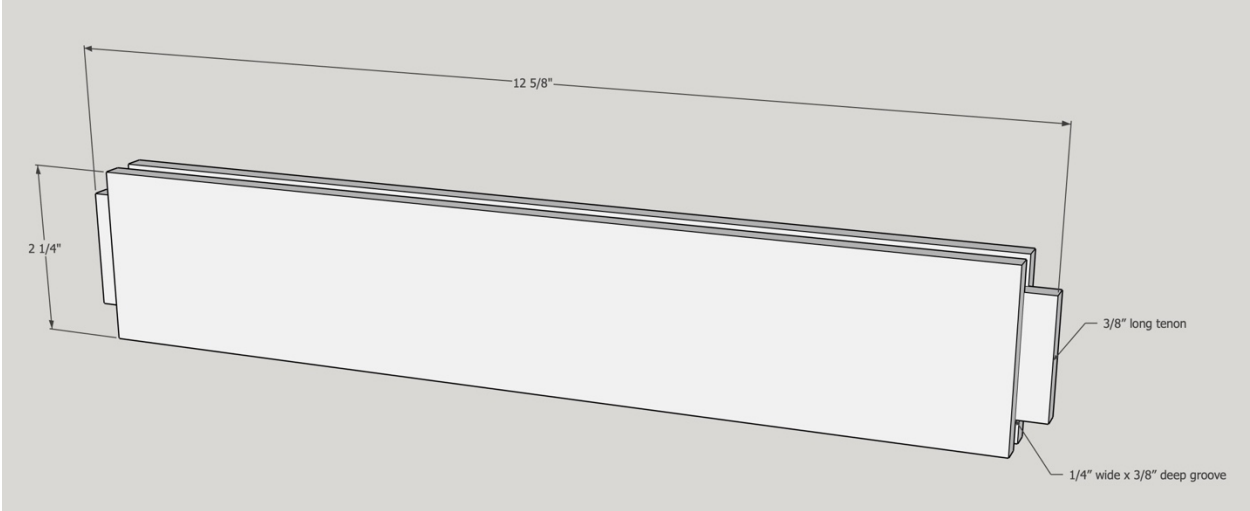

## BUILD THE UPPER CABINET DOORS

Build the upper cabinet door the same way you did the locker door. All door rails and stiles are 2 ¼” wide. Rip 1x3 boards to 2 ¼” wide. Measure, mark, and cut stiles to length. Cut a groove on one edge of the stiles. The groove should be ¼” wide x 3/8” deep. Measure, mark, and cut rails to length. Cut a groove on one edge of the top and bottom rails. Cut 3/8-inch long tenons on both ends of the rails. Assemble cabinet doors with wood glue.

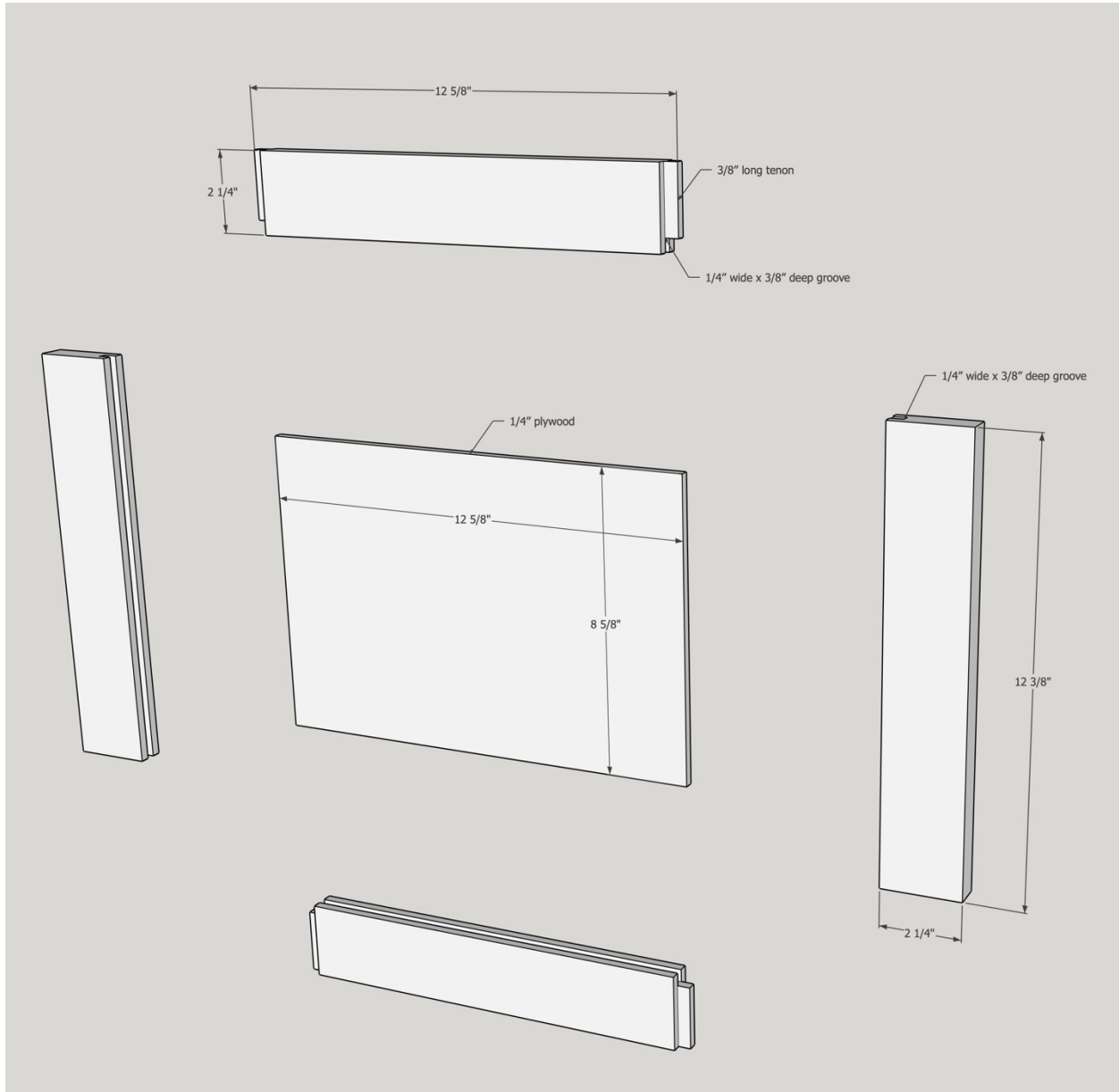

## INSTALL THE LOCKER DOORS AND UPPER CABINET DOORS

Use the concealed hinge jig to cut the mortise for the hinges. Attach the hinges to the doors, then mount the hinge plate to the carcasses. Clip the door hinges onto the cabinet mounts. Adjust the hinges as needed to achieve an even 1/8-inch reveal around the doors.

## FINISHING TOUCHES

Install cabinet latches, locker door pulls, magnetic door stops, and coat hooks.