

**Behind-the-Door Storage Shelf**

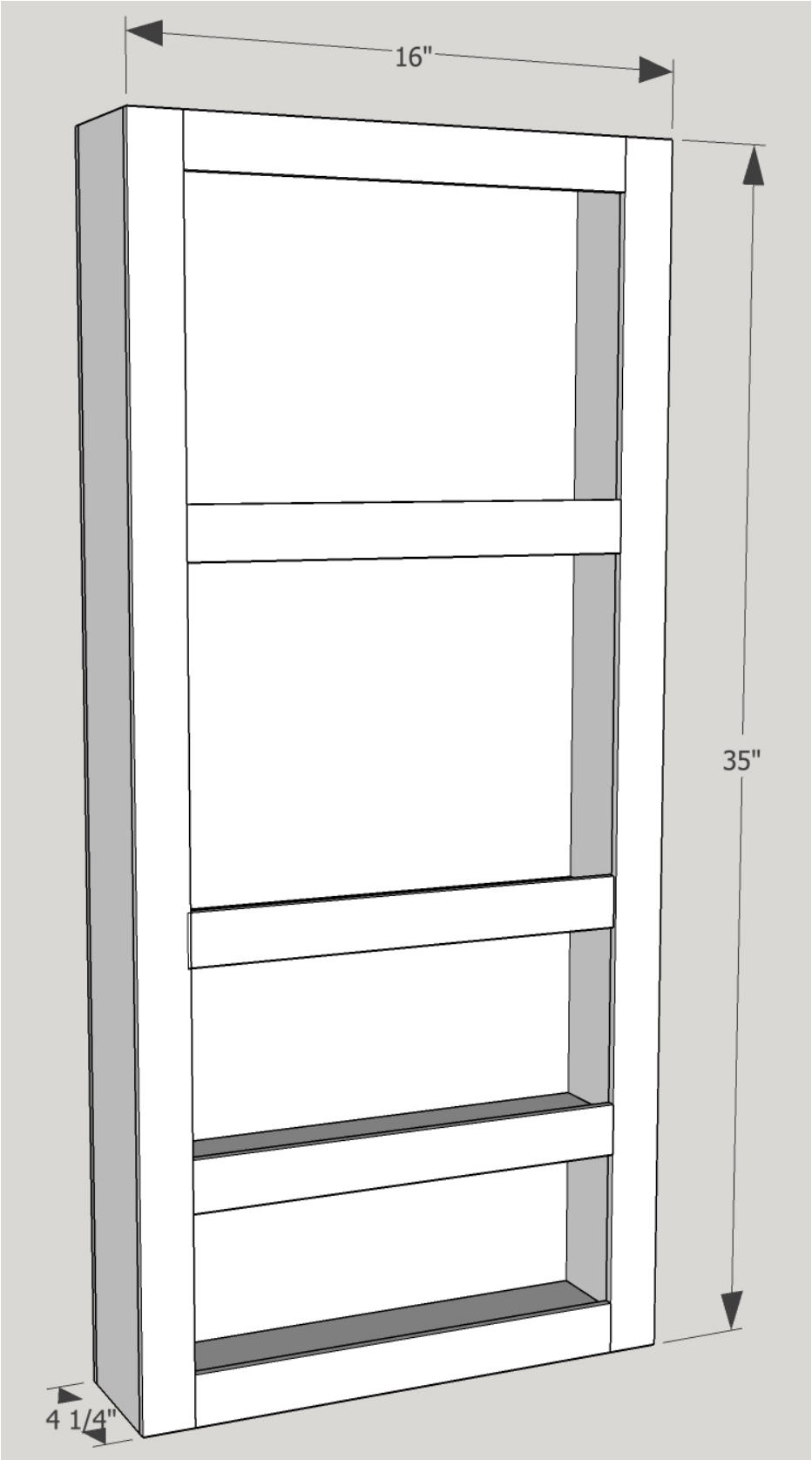

**MATERIALS:**

¾-inch Plywood ripped to 3 ¾-inch widths  
¼-inch Plywood  
Lattice Molding or Wood Lath  
1 ¼-inch Brad Nails  
1-inch Brad Nails  
Wood Glue  
Hanging Hardware

**TOOLS:**

Tape Measure  
Pencil  
Carpenter's Square  
Cordless Drill/Driver  
Table Saw  
Circular Saw or Miter Saw  
Brad Nailer or Hammer  
Shelf Pin Jig  
Safety Glasses  
Hearing Protection  
Dust Mask

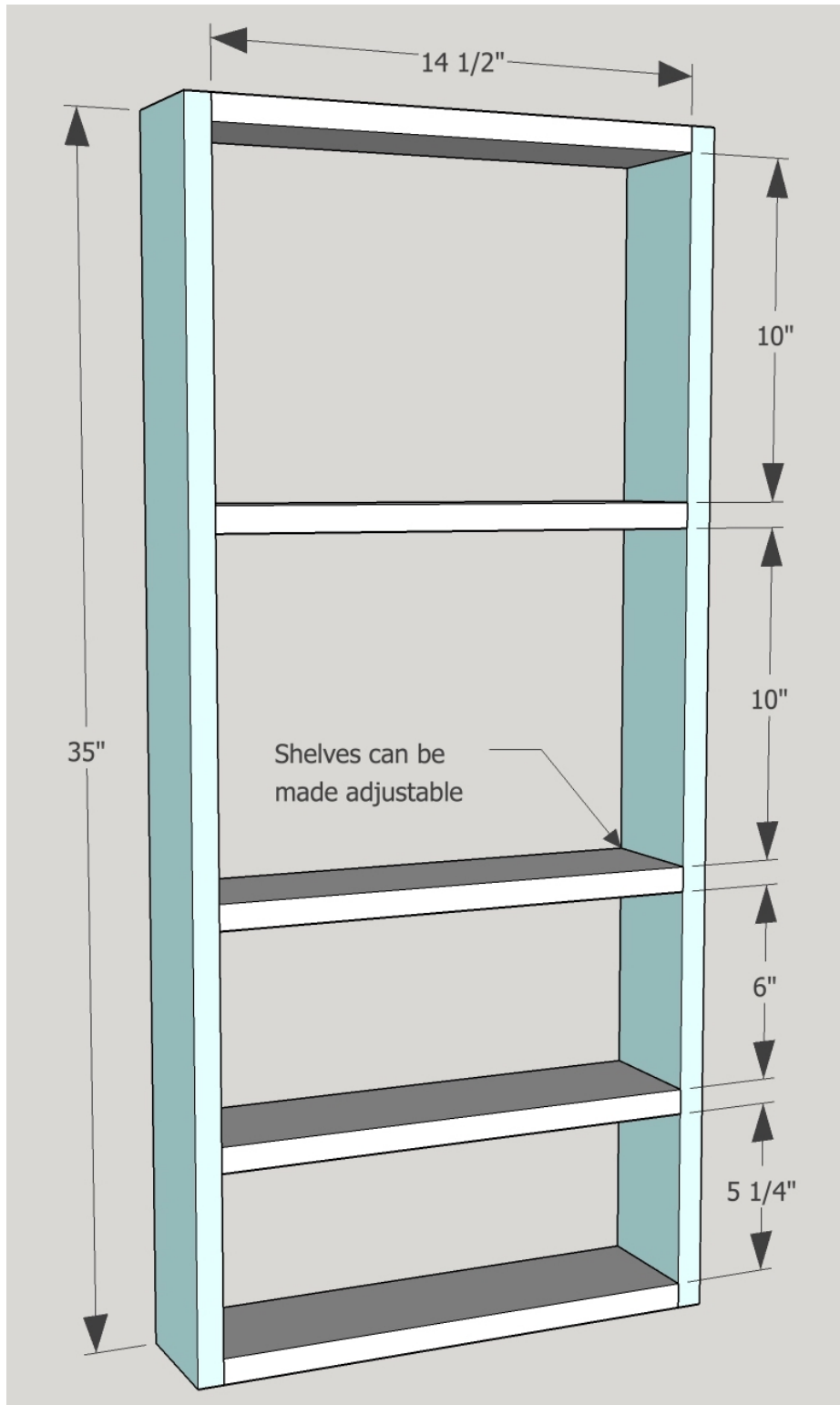
**STEP 1**

Using a table saw, rip the plywood down to 3 3/4-inch widths, then cut the boards to length with either a circular saw or miter saw. Construct as shown and attach with 1 1/4-inch brad nails and wood glue. Use a shelf pin jig if you'd like to make the shelves adjustable.

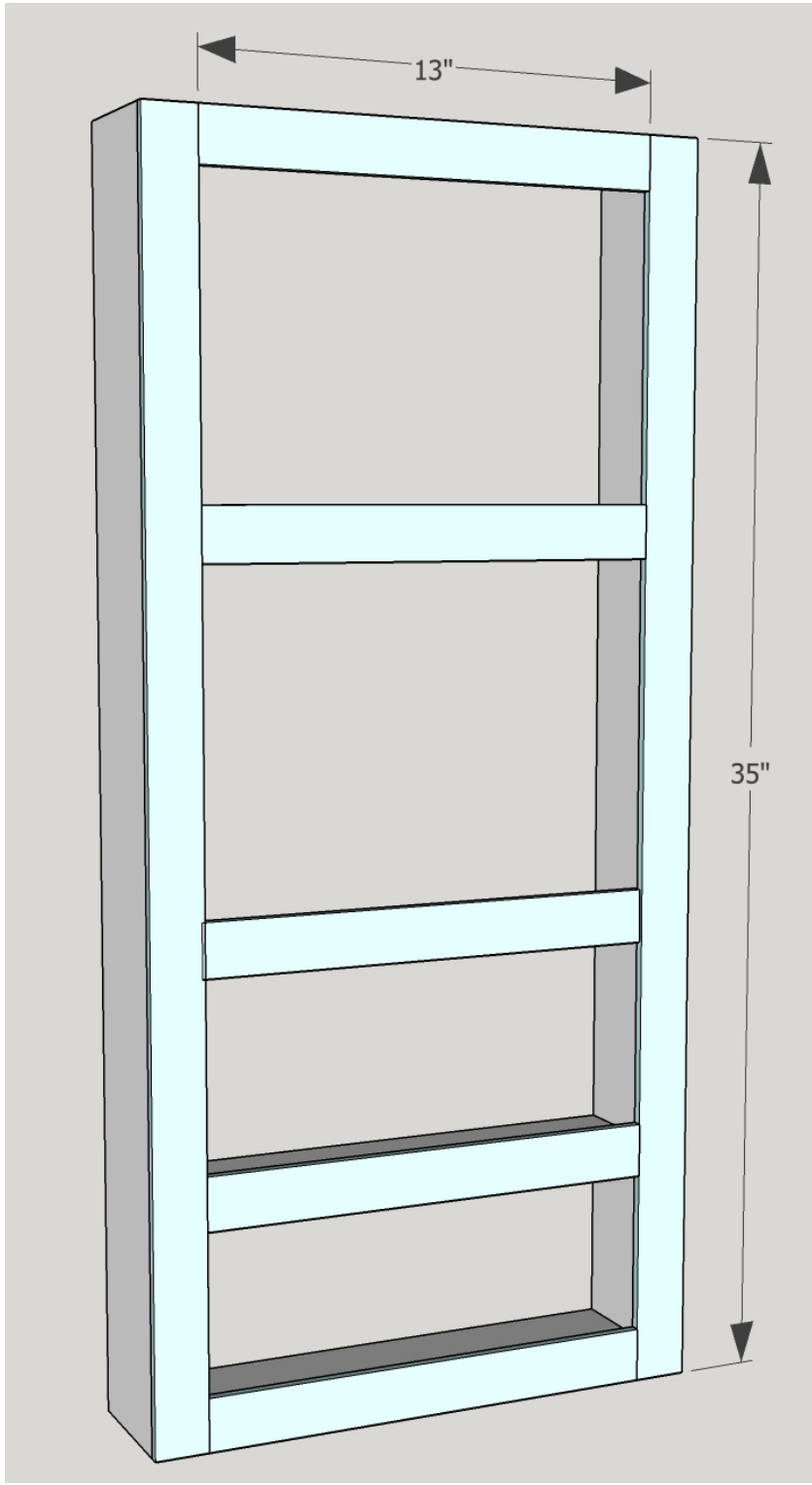
**STEP 2**

Measure, mark, and cut lattice molding or wood lath to length. You can also rip a 2x4 down to ¼-inch thick on a table saw to make the face frame. Attach the face frame trim to the storage shelf with 1-inch brad nails and wood glue. If you're making the shelves adjustable, remember to attach the rails only to the shelves, so that they may move freely along with the shelves.

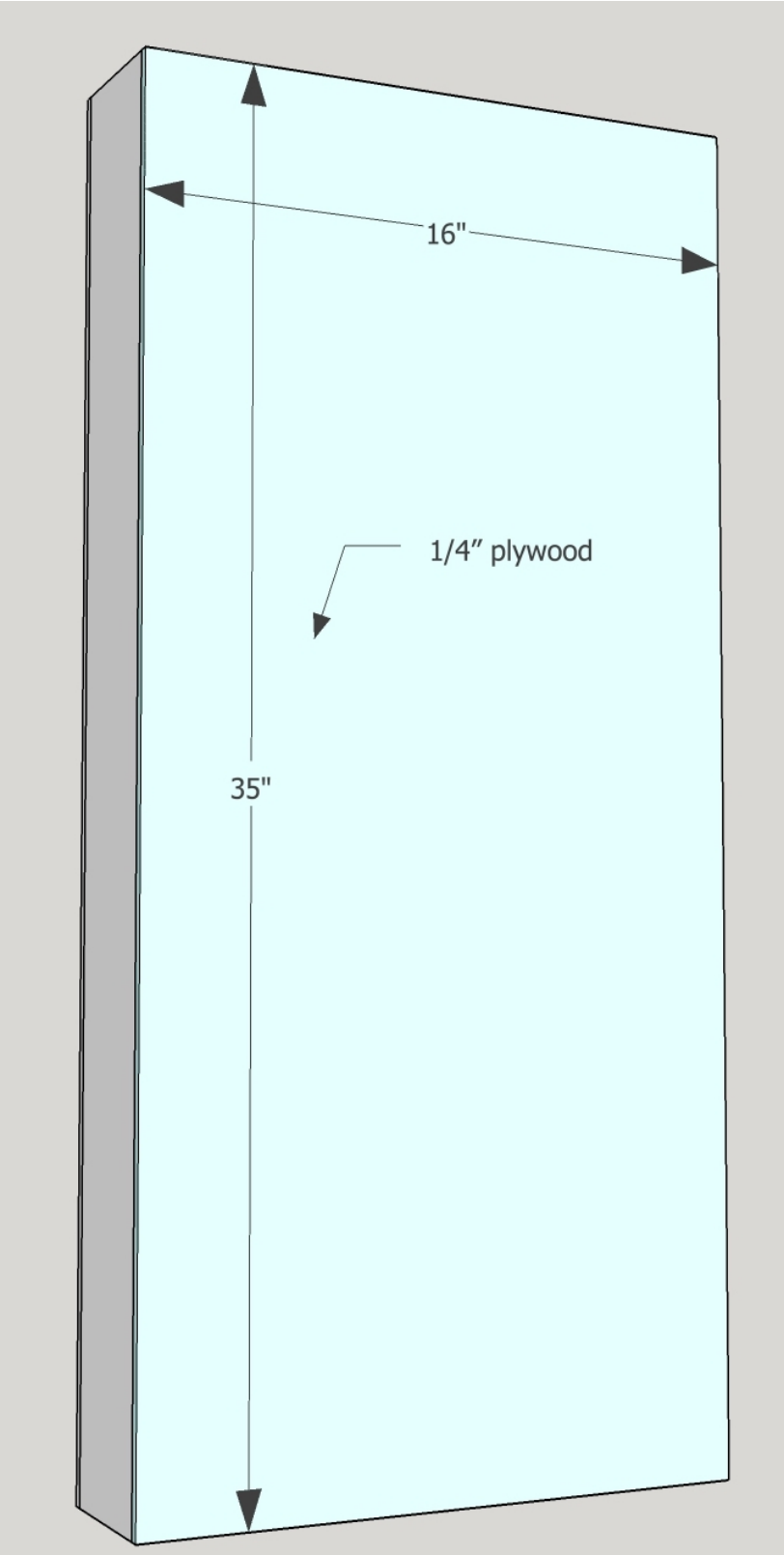

**STEP 3**

Measure, mark, and cut ¼-inch plywood to size. Attach it to the back of the storage shelf with 1-inch brad nails and wood glue.

