

TWIN BUILT-IN BUNK BED

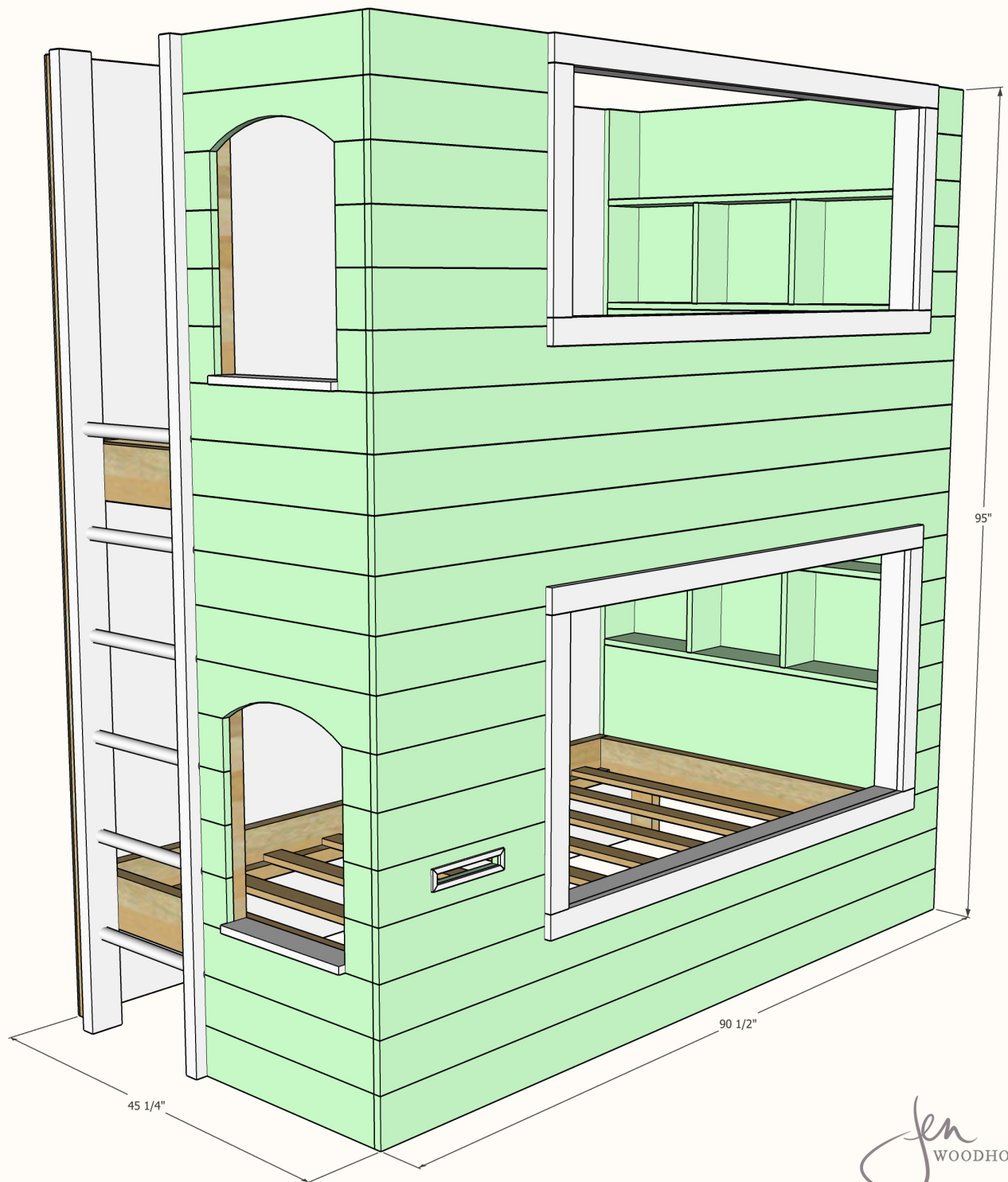

Jen
WOODHOUSE

MATERIALS:

- ☐ (2) 4 x 8 Ft. Sheets of ¾-inch Plywood
- ☐ (6) 2 x 6 x 8 Ft. Boards
- ☐ (17) 2 x 4 x 8 Ft. Boards
- ☐ (15) 1 x 6 x 8 Ft. Tongue & Groove Boards
- ☐ (9) 1 x 4 x 8 Ft. Boards
- ☐ (10) 1 x 3 x 8 Ft. Boards
- ☐ (2) 6 Ft. 1 ¼-inch Dowels
- ☐ 3-inch Wood Screws
- ☐ 2 ½-inch Wood and Pocket Screws
- ☐ 1 ¼-inch Wood Screws and Brad Nails
- ☐ Wood Glue

TOOLS:

- ☐ Tape Measure
- ☐ Speed Square
- ☐ Cordless Drill/Driver
- ☐ Table Saw
- ☐ Miter Saw
- ☐ Jig Saw
- ☐ Pocket Hole Jig
- ☐ Pneumatic Brad Nailer
- ☐ Stud Finder
- ☐ Level
- ☐ 1 ¼-inch Spade Bit
- ☐ Safety Glasses
- ☐ Hearing Protection
- ☐ Dust Mask

CUT LIST:**Framework:**

- ☐ (11) 2x4 @ 95 inches (legs)
- ☐ (3) 2x4 @ 36 inches (rails)
- ☐ (3) 2x4 @ 59 ½ inches (rails)
- ☐ (3) 2x4 @ 16 inches (rails)
- ☐ (6) 1 ¼-inch dowels @ 18 inches (rungs)

Bed Box:

- ☐ (4) 2x6 @ 86 ¾ inches (long sides)
- ☐ (4) 2x6 @ 40 inches (short sides)
- ☐ (4) 2x2 @ 77 inches (mattress cleats)
- ☐ (20) 1x3 @ 40 inches (mattress slats)

Side Cladding:

- ☐ (11) 1x6 T&G @ 23 inches
- ☐ (16) 1x6 T&G @ 3 ½ inches

Front Cladding:

- ☐ (8) 1x6 T&G @ 90 ½ inches
- ☐ (11) 1x6 T&G @ 22 ¾ inches
- ☐ (11) 1x6 T&G @ 8 ¼ inches

Windows:

**These 1x4 boards should be ripped to 3 inches wide.*

- ☐ (4) 1x4 @ 59 ½ inches (casing)
- ☐ (2) 1x4 @ 28 inches (casing)
- ☐ (2) 1x4 @ 21 ¾ inches (casing)
- ☐ (4) 1x4 @ 63 inches (trim)
- ☐ (2) 1x4 @ 28 inches (trim)
- ☐ (2) 1x4 @ 21 ¾ inches (trim)
- ☐ (2) 1x4 @ 16 inches (ledge)

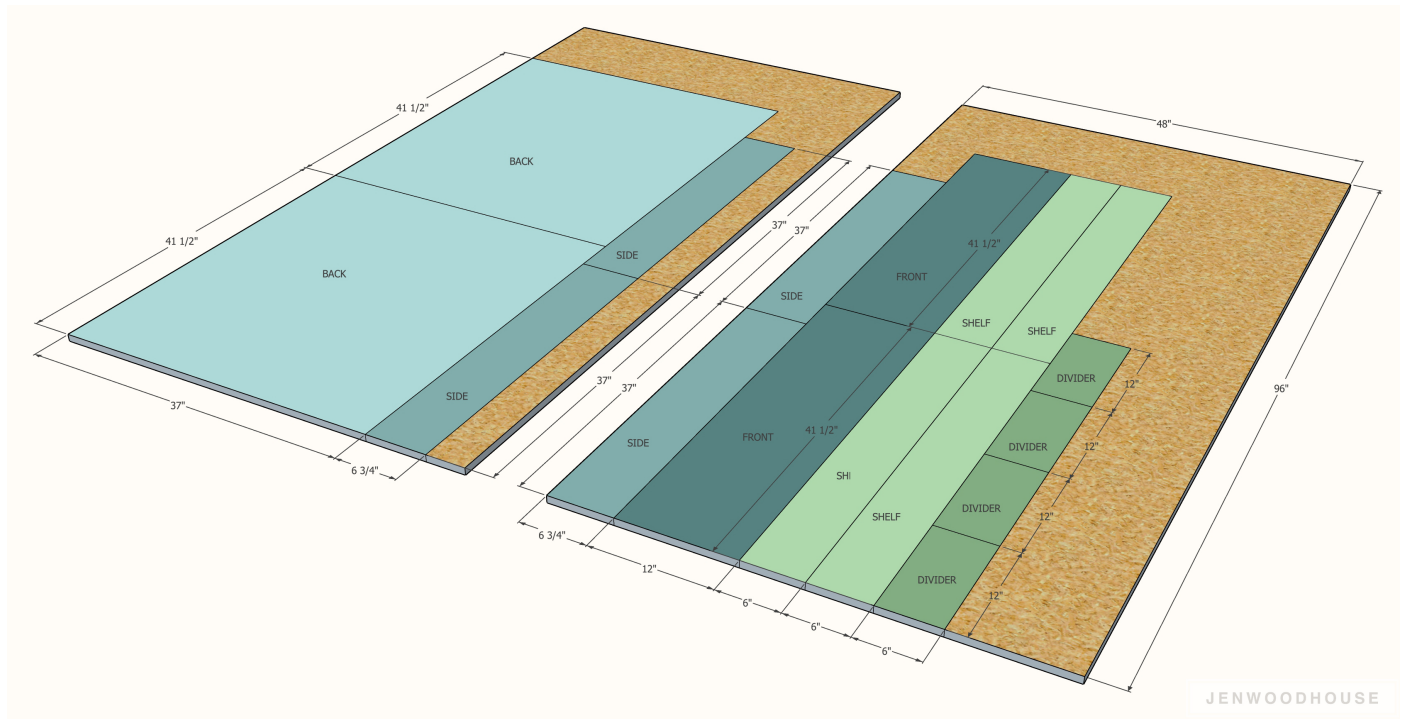

Shelf Units:

- ☐ (2) 3/4-inch plywood @ 41 1/2 inches x 37 inches (back)
- ☐ (2) 3/4-inch plywood @ 41 1/2 inches x 12 inches (front)
- ☐ (4) 3/4-inch plywood @ 41 1/2 inches x 6 inches (shelf)
- ☐ (4) 3/4-inch plywood @ 37 inches x 6 3/4 inches (side)
- ☐ (4) 3/4-inch plywood @ 12 inches x 6 inches (divider)

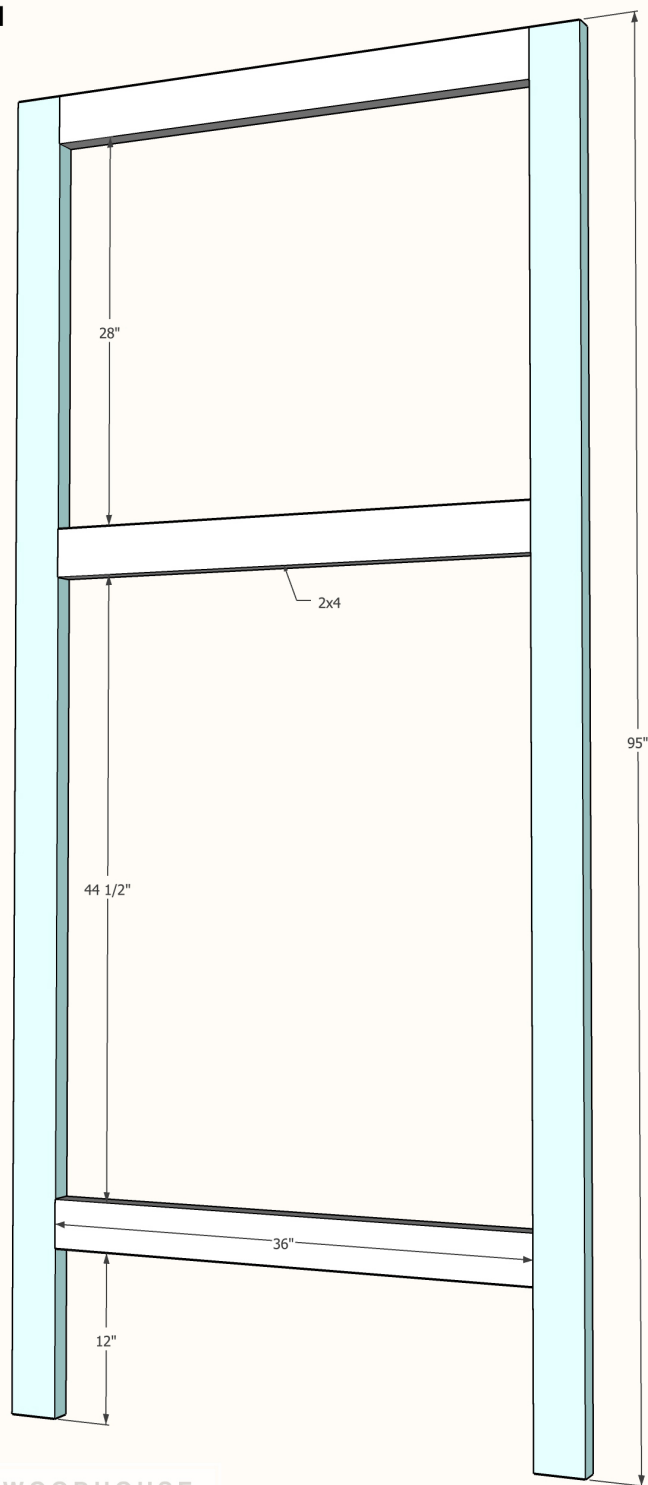
FIG 1

JENWOODHOUSE

STEP 1

Measure, mark, and cut 2x4 boards to length. Drill 1 1/2-inch pocket holes into the rails and attach them to the legs with 2 1/2-inch pocket screws and wood glue. Construct the frame as shown. Use a stud finder to locate the studs in the wall and screw the constructed frame to the wall studs with 3-inch wood screws.

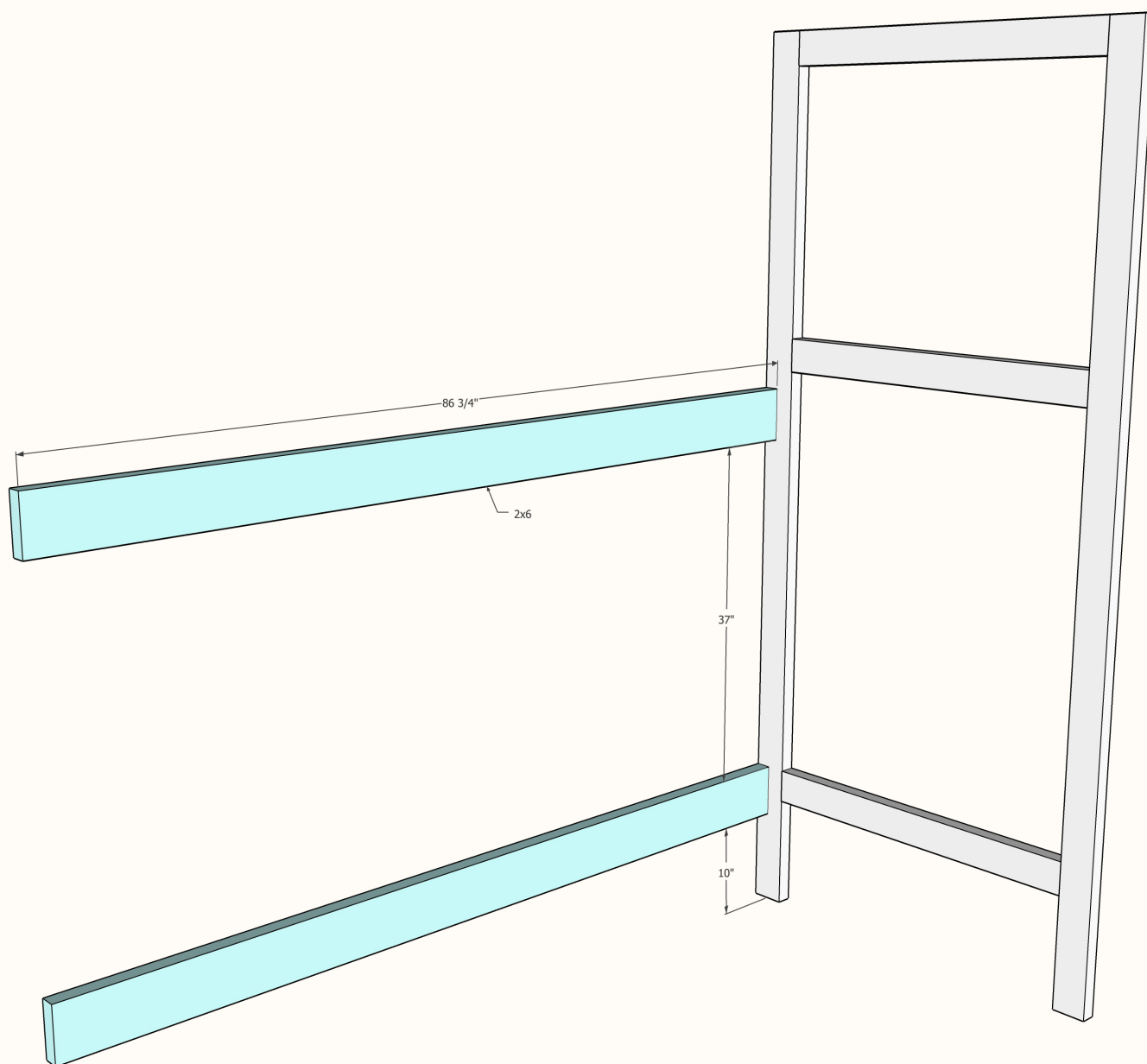
FIG 2

JENWOODHOUSE

STEP 2:

Measure, mark, and cut 2x6 boards to length. Drill 1 ½-inch pocket holes into one end and attach to the 2x4 with 2 ½-inch pocket screws. Locate the studs in the wall, make sure the 2x6 boards are level before screwing them to the wall studs with 3-inch wood screws.

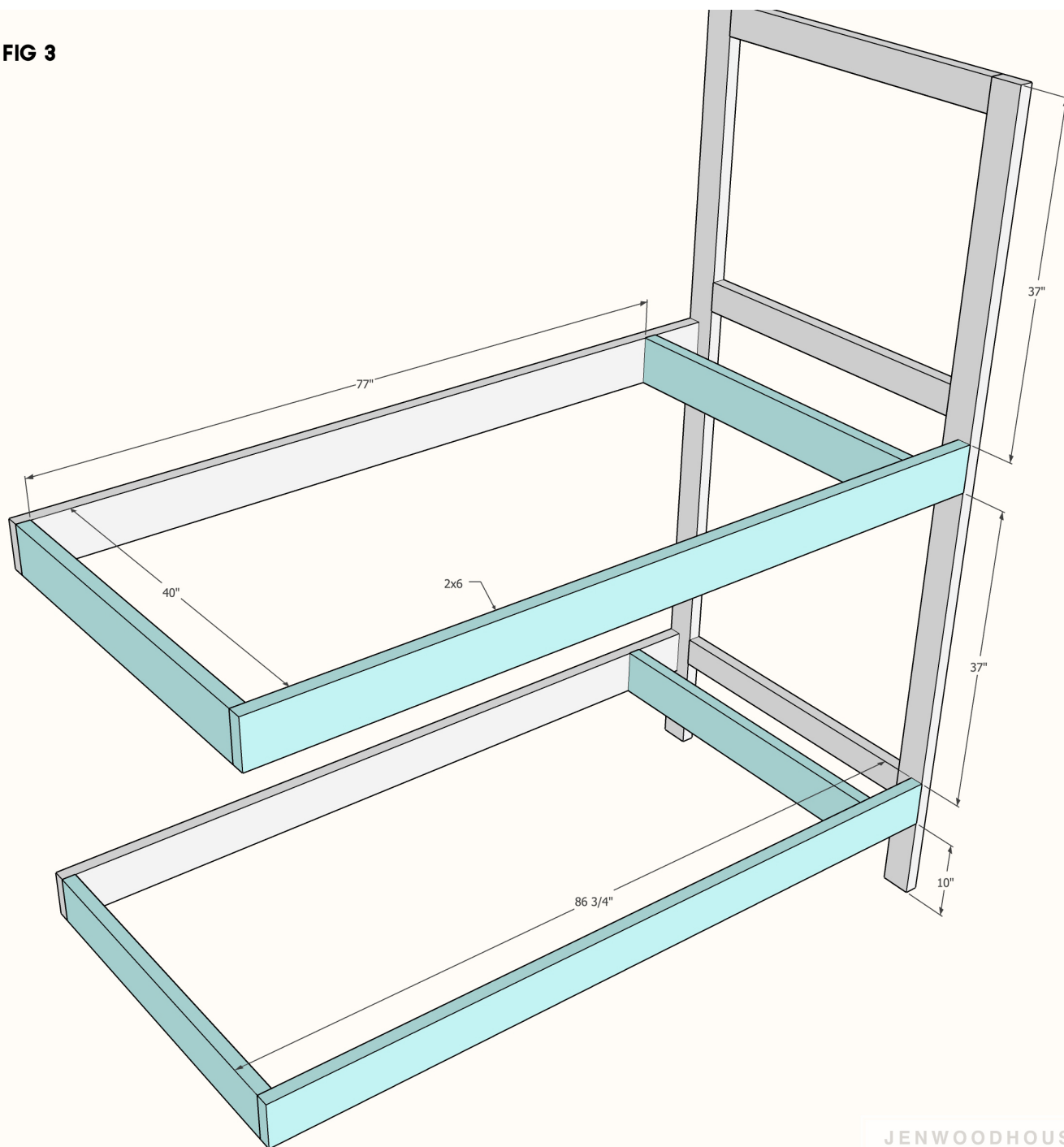
FIG 3**STEP 3:**

Measure, mark, and cut 2x6 boards to length. Drill 1 ½-inch pocket holes into the ends and attach them as shown with 2 ½-inch pocket screws. Check for level and square. Adjust as necessary. You may want to temporarily screw a scrap 2x4 board to act as a support to make it easier while you construct the bed box.

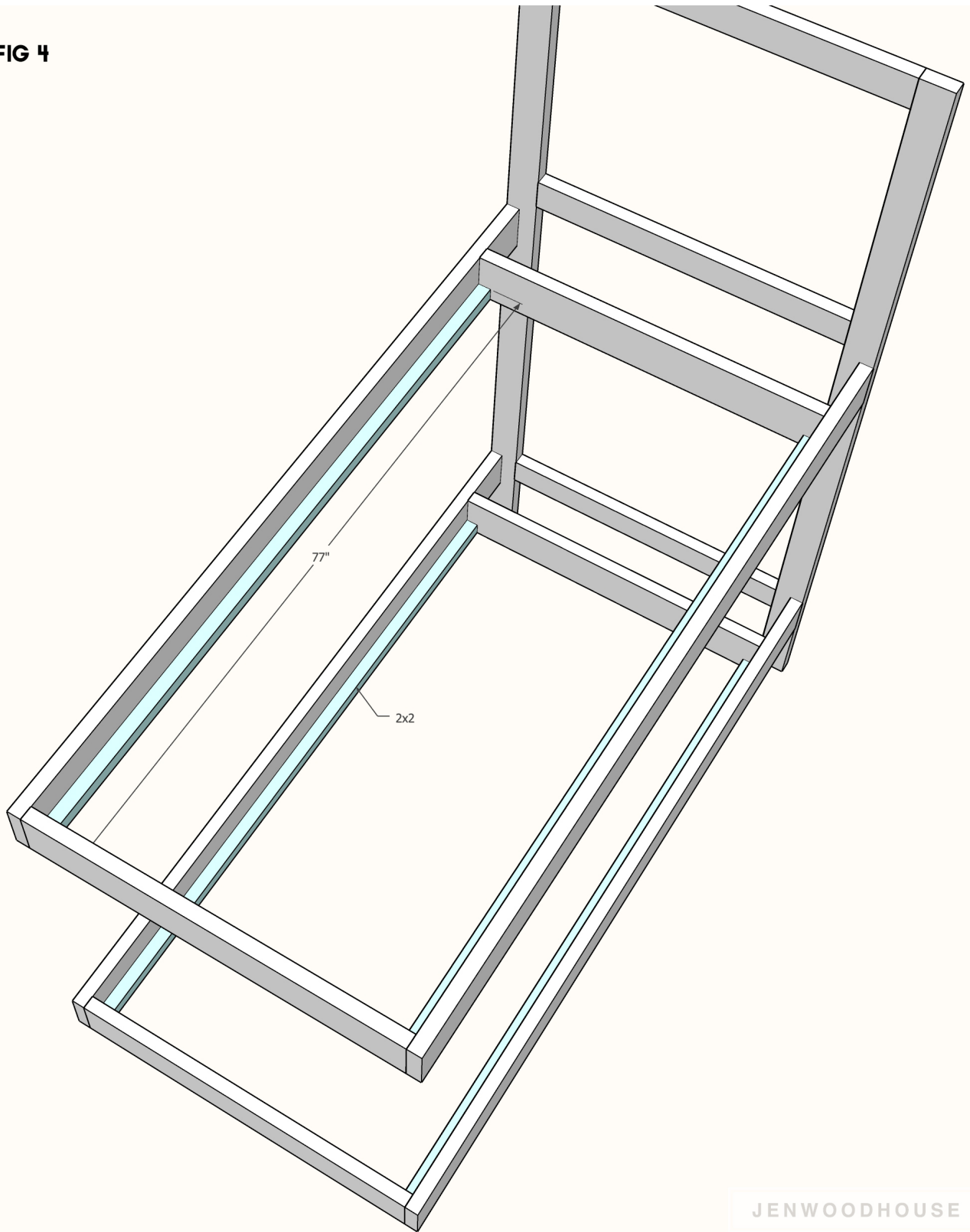
FIG 4**STEP 4:**

Measure, mark, and cut two 2x4 boards to length. Rip them in half on the table saw to make the 2x2 mattress cleats. Pre-drill pilot holes and attach the cleats to the long sides of the bed box with 2 ½-inch wood screws and wood glue.

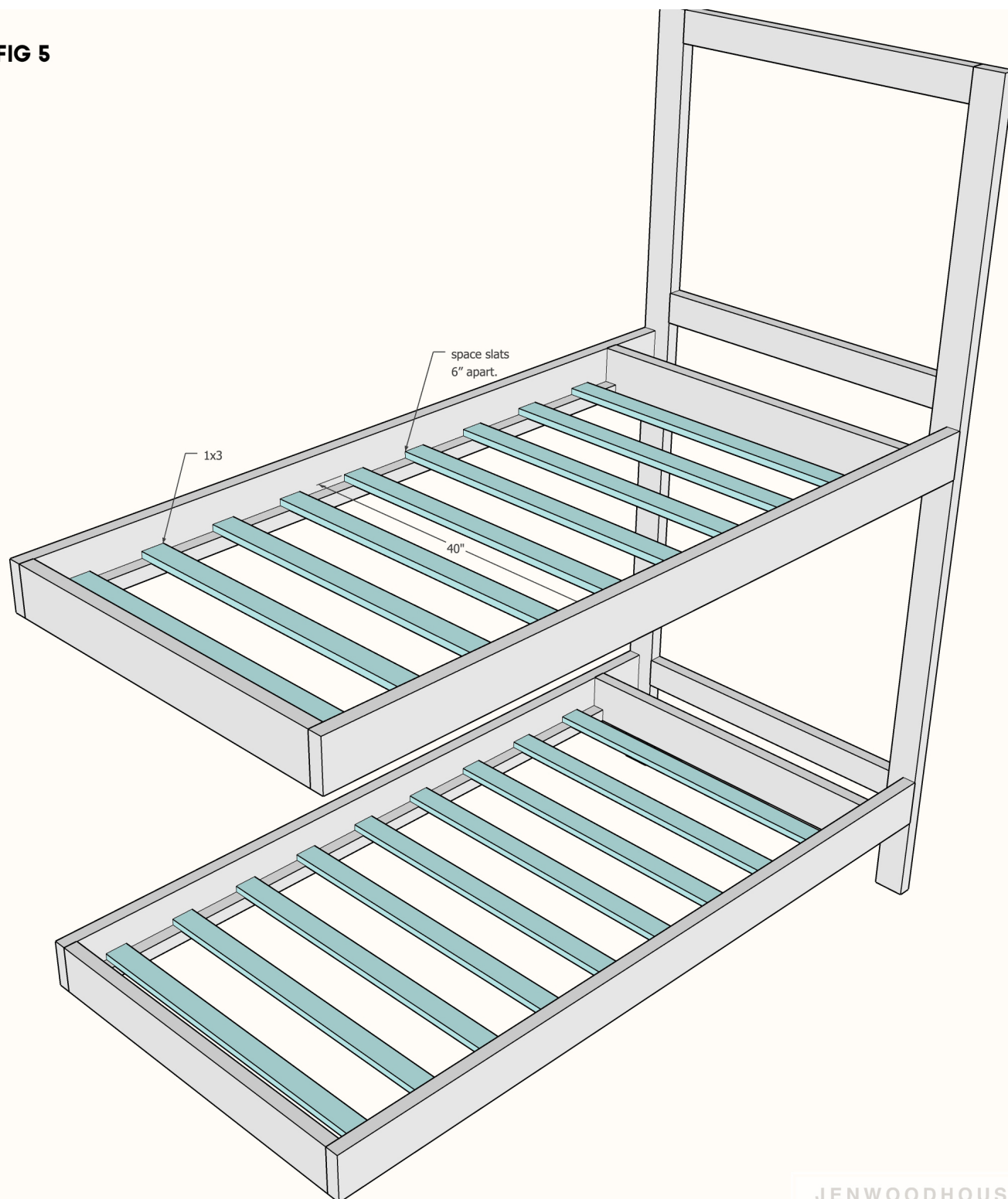
FIG 5

JENWOODHOUSE

STEP 5:

Measure, mark, and cut 1x3 mattress slats to length. Pre-drill pilot holes and attach the slats to the mattress cleats with 1 ¼-inch wood screws. Space slats about 6 inches apart. You may want to save this for last, so you're still able to step inside to install the rest of the parts.

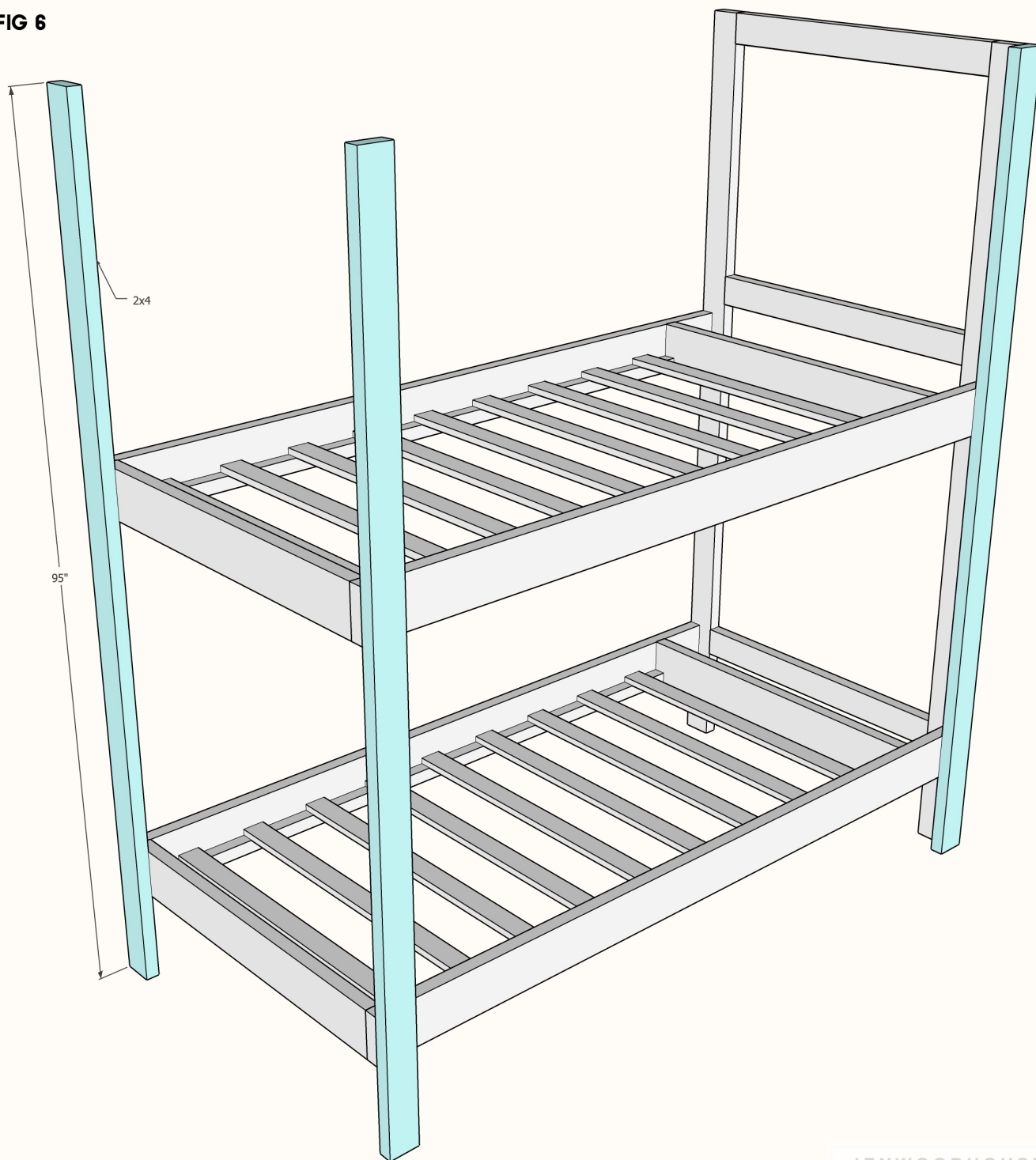
FIG 6

JENWOODHOUSE

STEP 6:

Measure, mark, and cut 2x4 boards to length. Position the boards at the three corners as shown, check for plumb, and attach them to the framework with 2 ½-inch wood screws.

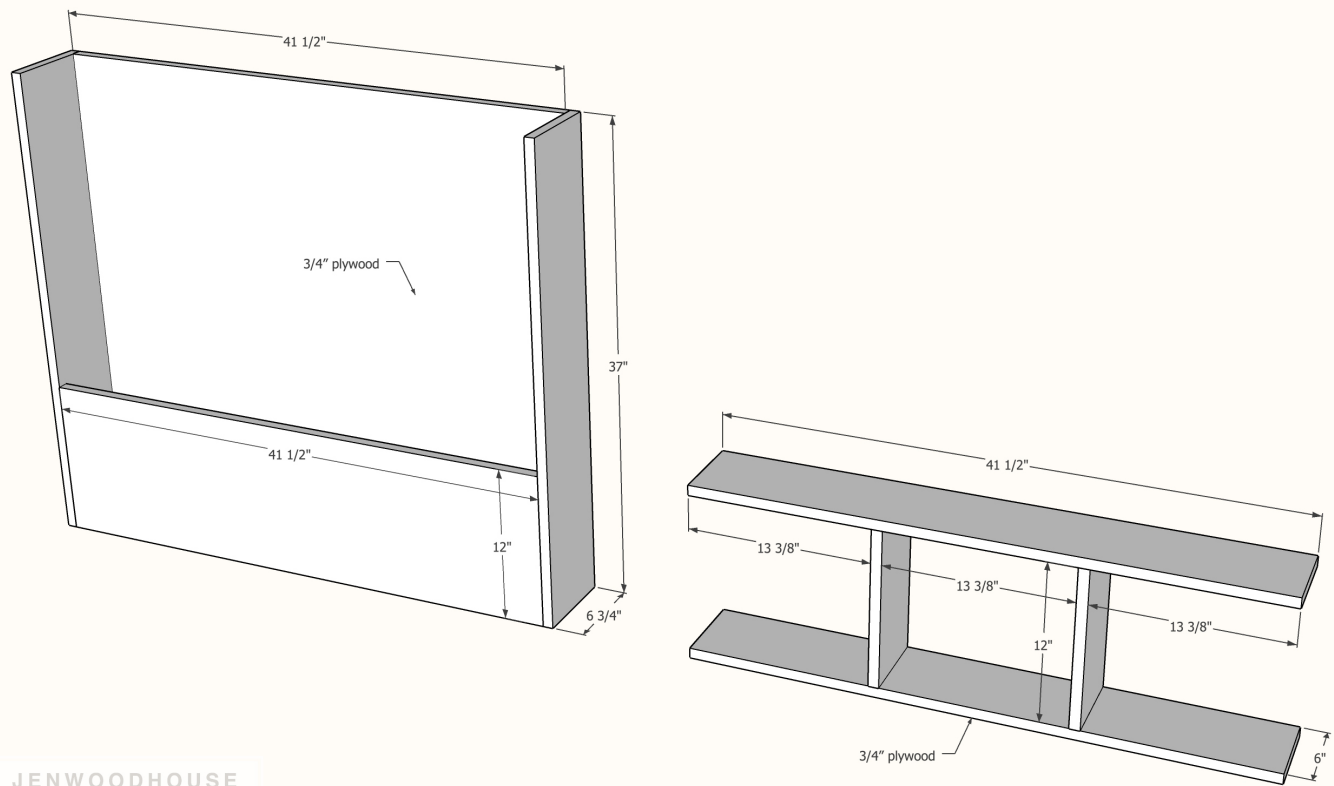
FIG 7A**STEP 7a:**

Measure, mark, and cut plywood backs and sides to size. Construct parts as shown and attach with 1 1/4-inch brad nails and wood glue.

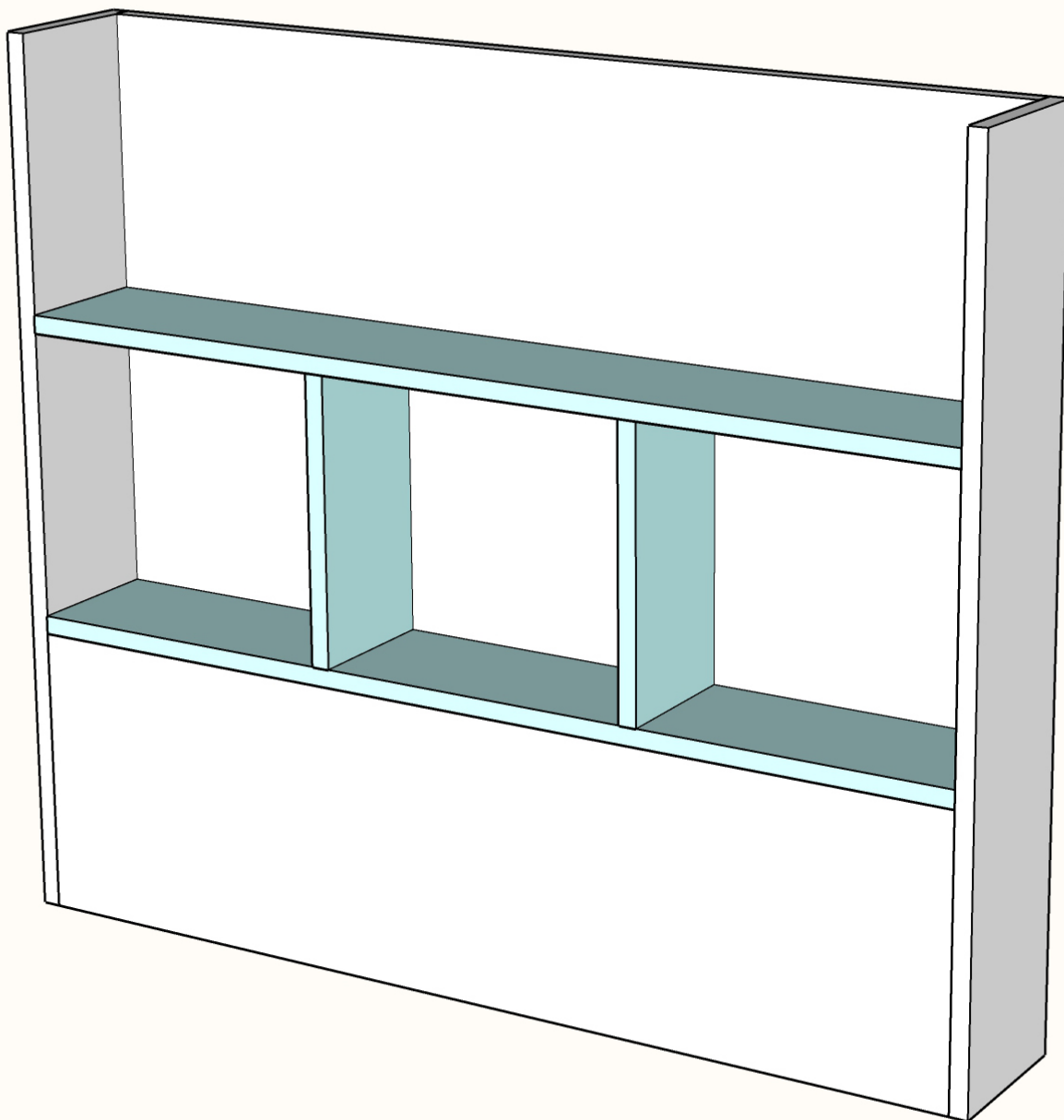
FIG 7B

JENWOODHOUSE

STEP 7b:

Measure, mark, and cut shelves and dividers to size. Construct shelves first with 1 ¼-inch brad nails and wood glue, before attaching to the unit. Then slide constructed shelves into place and secure to unit with 1 ¼-inch brad nails and wood glue.

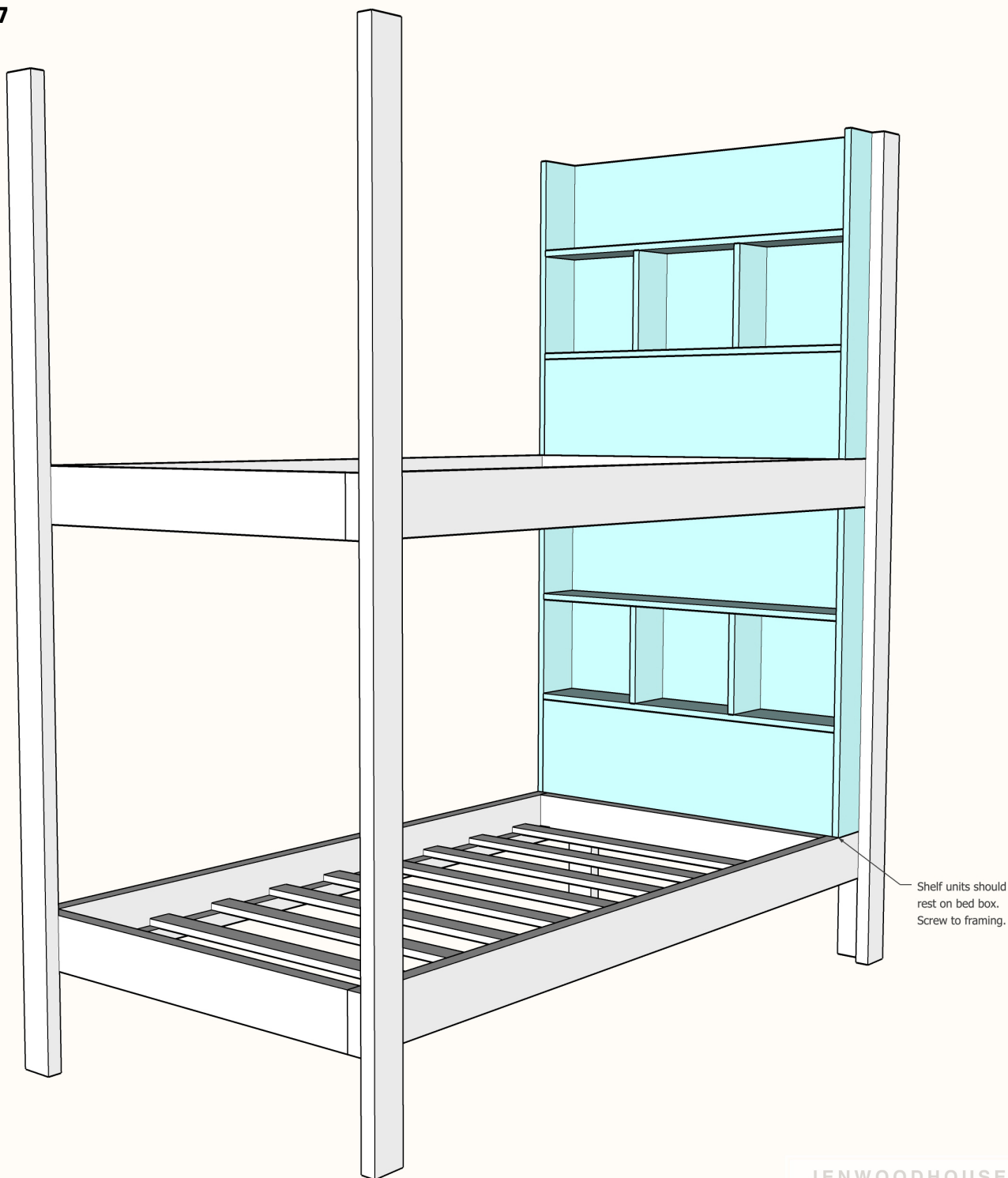
FIG 7

JENWOODHOUSE

STEP 7:

Install shelf units by setting them on the bed box and screwing them to the framework with 1 ¼-inch wood screws.

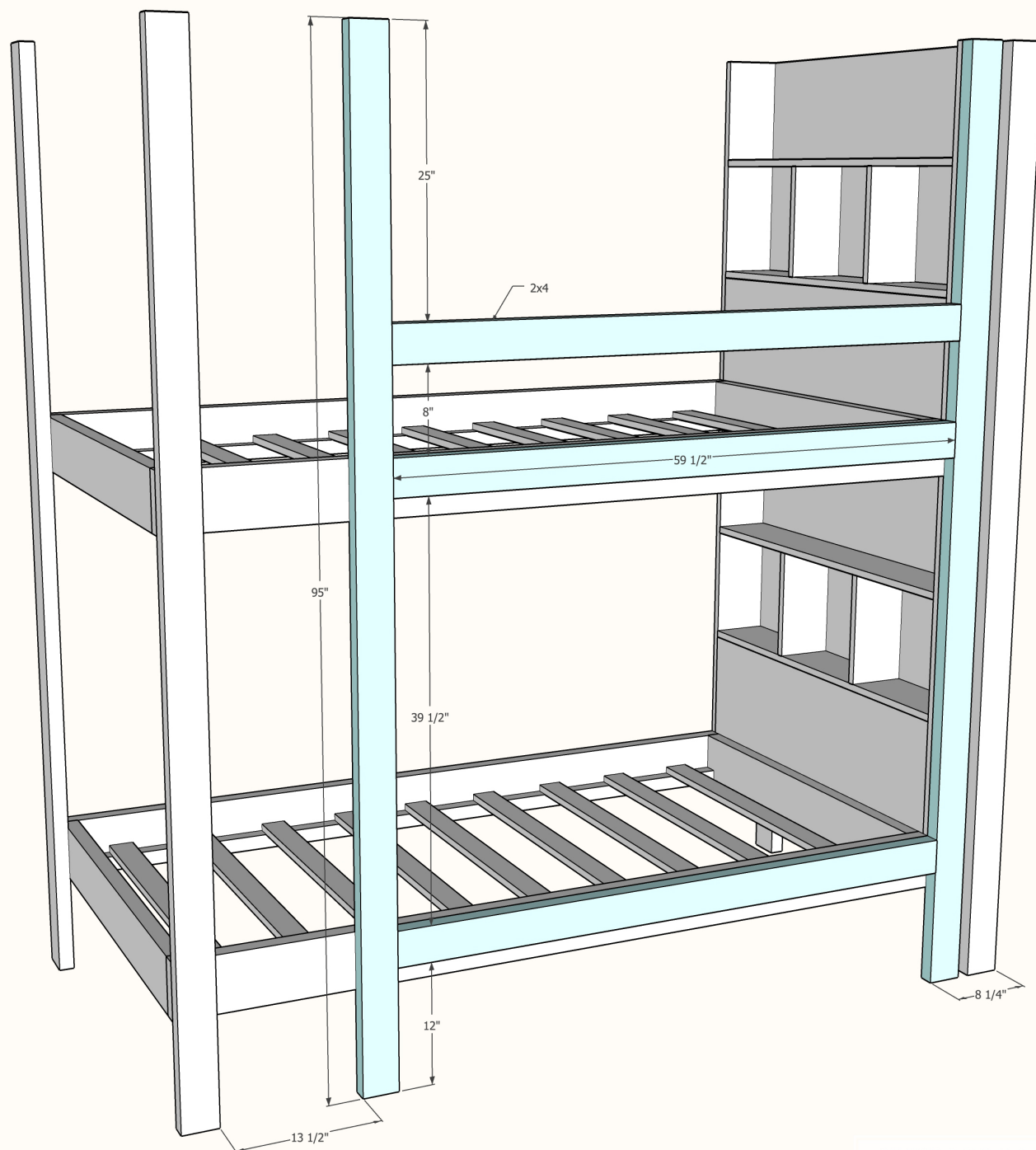
FIG 8

JENWOODHOUSE

STEP 8:

Measure, mark, and cut 2x4 boards to length. Drill 1 ½-inch pocket holes into the rails and attach them to the vertical boards with 2 ½-inch pocket screws and wood glue. Attach to the constructed frame to the bed with 2 ½-inch wood screws.

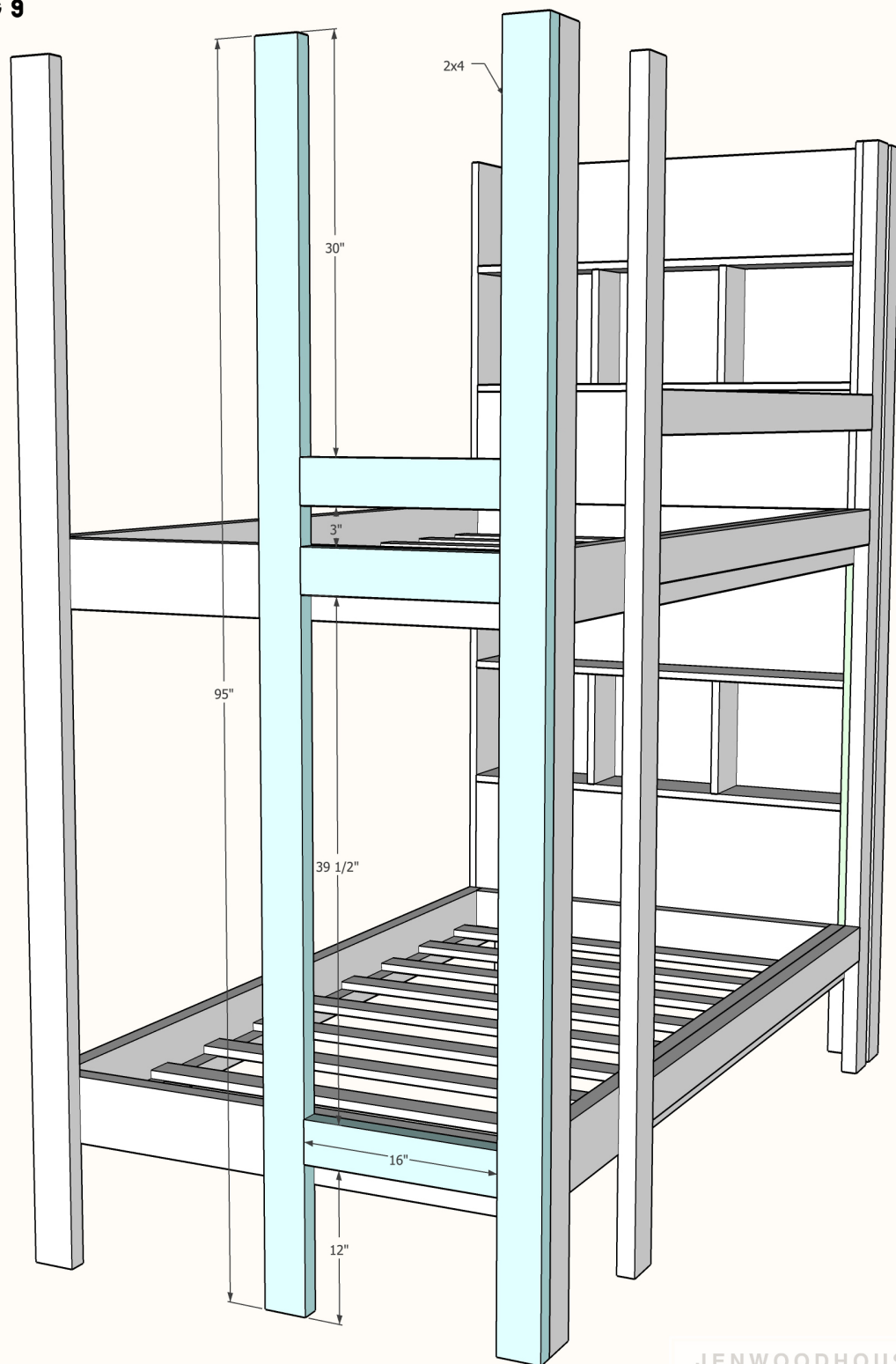
FIG 9**STEP 9:**

Measure, mark, and cut 2x4 boards to length. Drill 1 ½-inch pocket holes into the rails and attach to the legs with 2 ½-inch pocket screws and wood glue. Attach constructed frame to bunk bed with 2 ½-inch wood screws. Check for plumb and adjust as necessary.

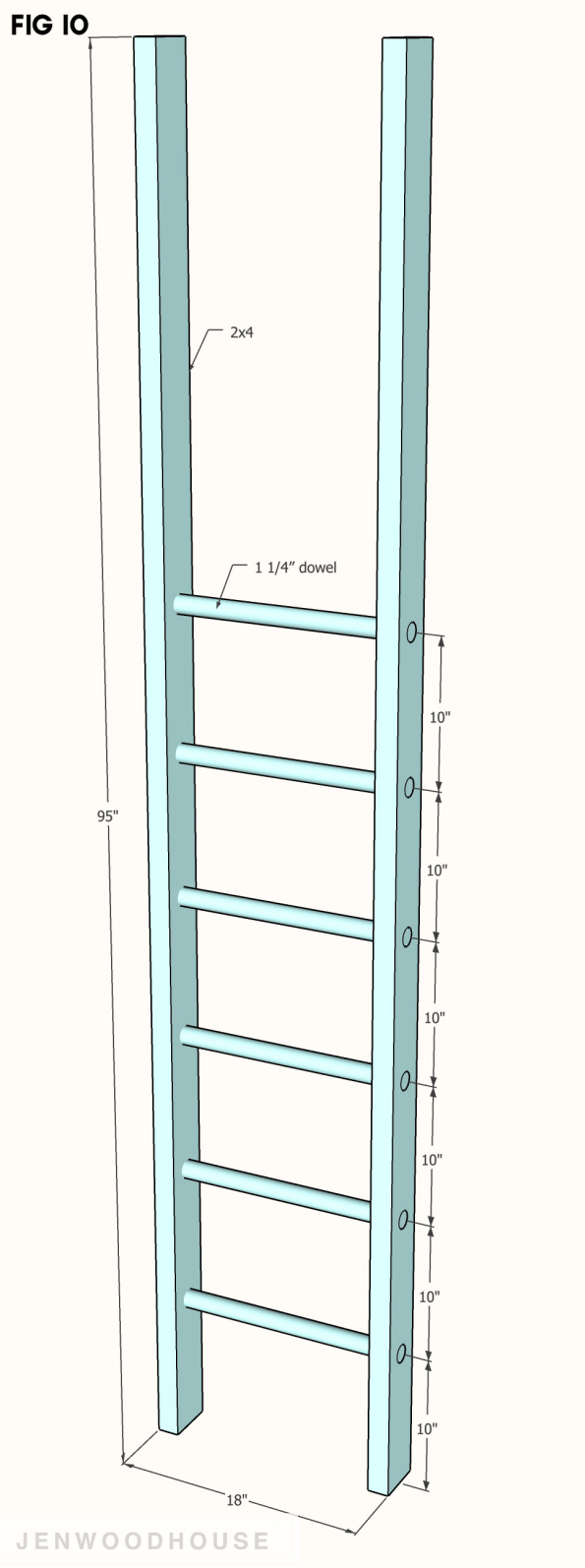
**STEP 10:**

Measure, mark, and cut 2x4 ladder legs and dowels to length. Clamp the legs together and use a 1 1/4-inch spade bit to drill a hole for the ladder rungs. Use a mallet to tap the dowels into place.

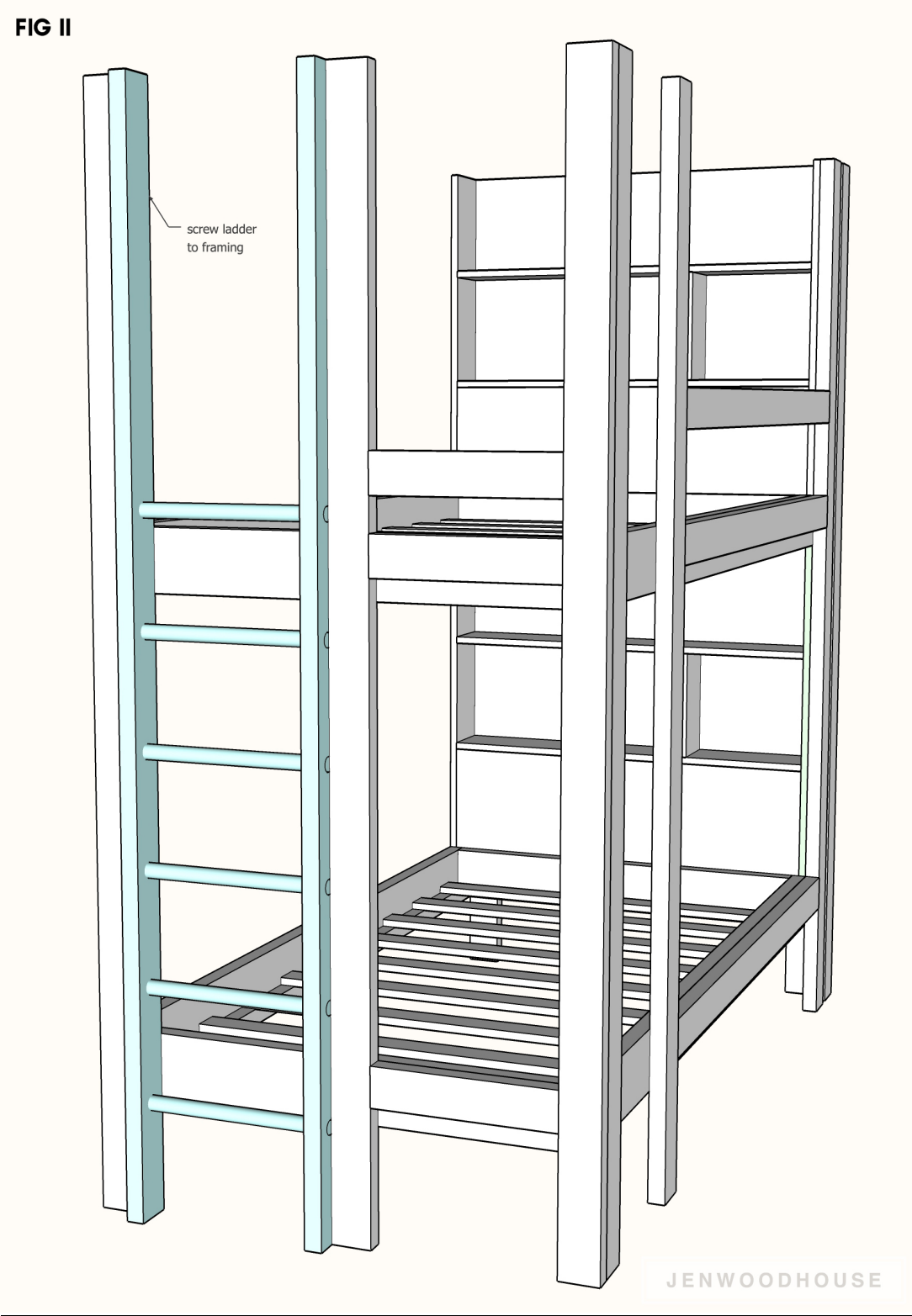

STEP 11:
Screw the constructed ladder to the bunk bed with 2 ½-inch wood screws.

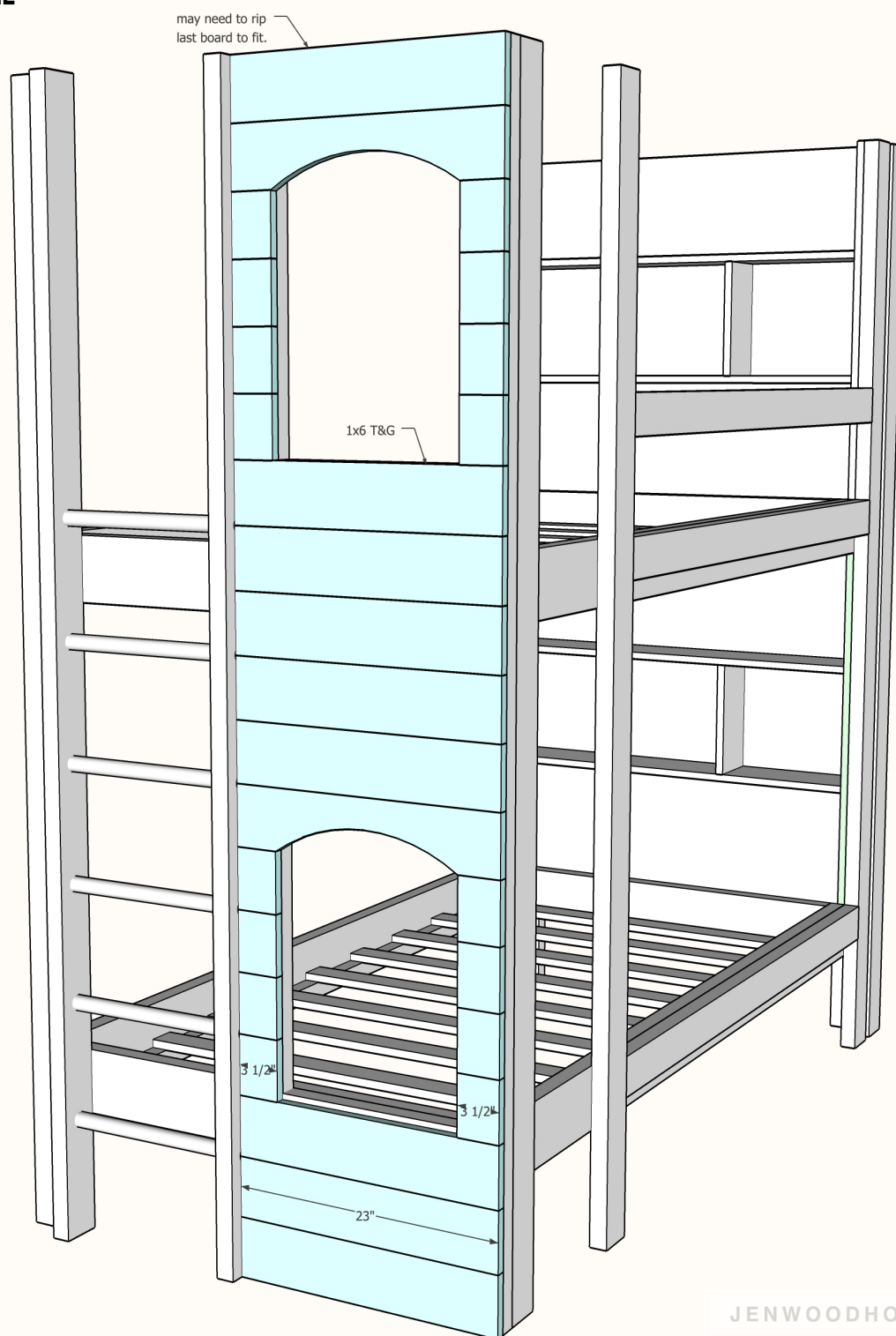
FIG 12

JENWOODHOUSE

STEP 12:

Measure, mark, and cut T&G boards to length. Use a jigsaw to cut the curved parts of the window. Starting at the bottom with the tongue facing up, attach the first board to the 2x4 framing with 1 ¼-inch brad nails. Work your way up to the top. You may need to rip the last board to fit.

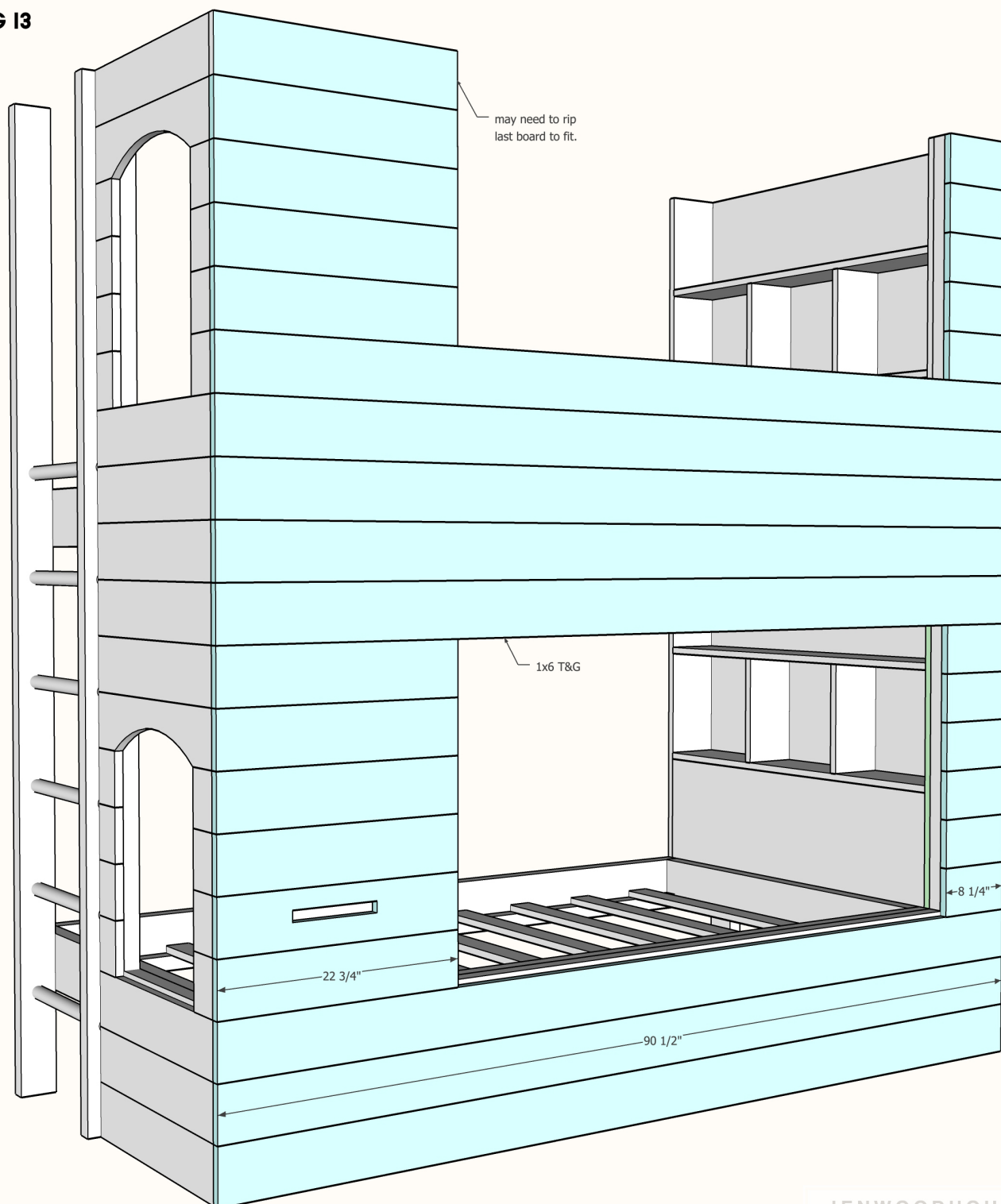
FIG 13

JENWOODHOUSE

STEP 13:

Measure, mark, and cut 1x6 T&G boards to length. Optional: Use a jigsaw to cut a mail slot into one of the boards as shown. Starting at the bottom with the tongue facing up, attach the first board to the 2x4 framework with 1 1/4-inch brad nails. Work your way up to the top. You may need to rip the last board to fit.

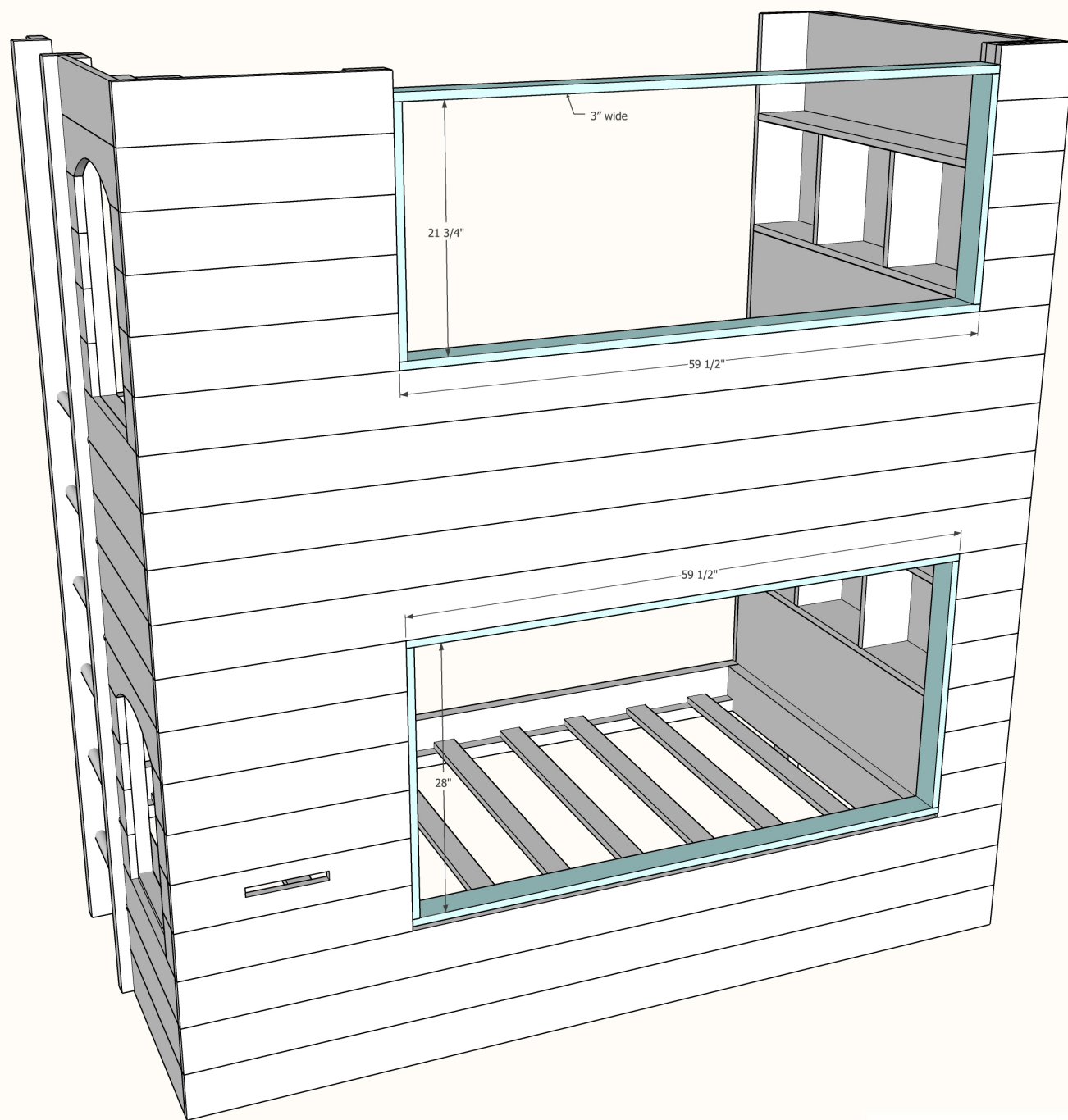
FIG 14**STEP 14:**

Measure, mark, and rip-cut 1x4 boards to 3 inches wide. Cut to length and attach to windows with 1 1/4-inch countersunk wood screws.

FIG 15

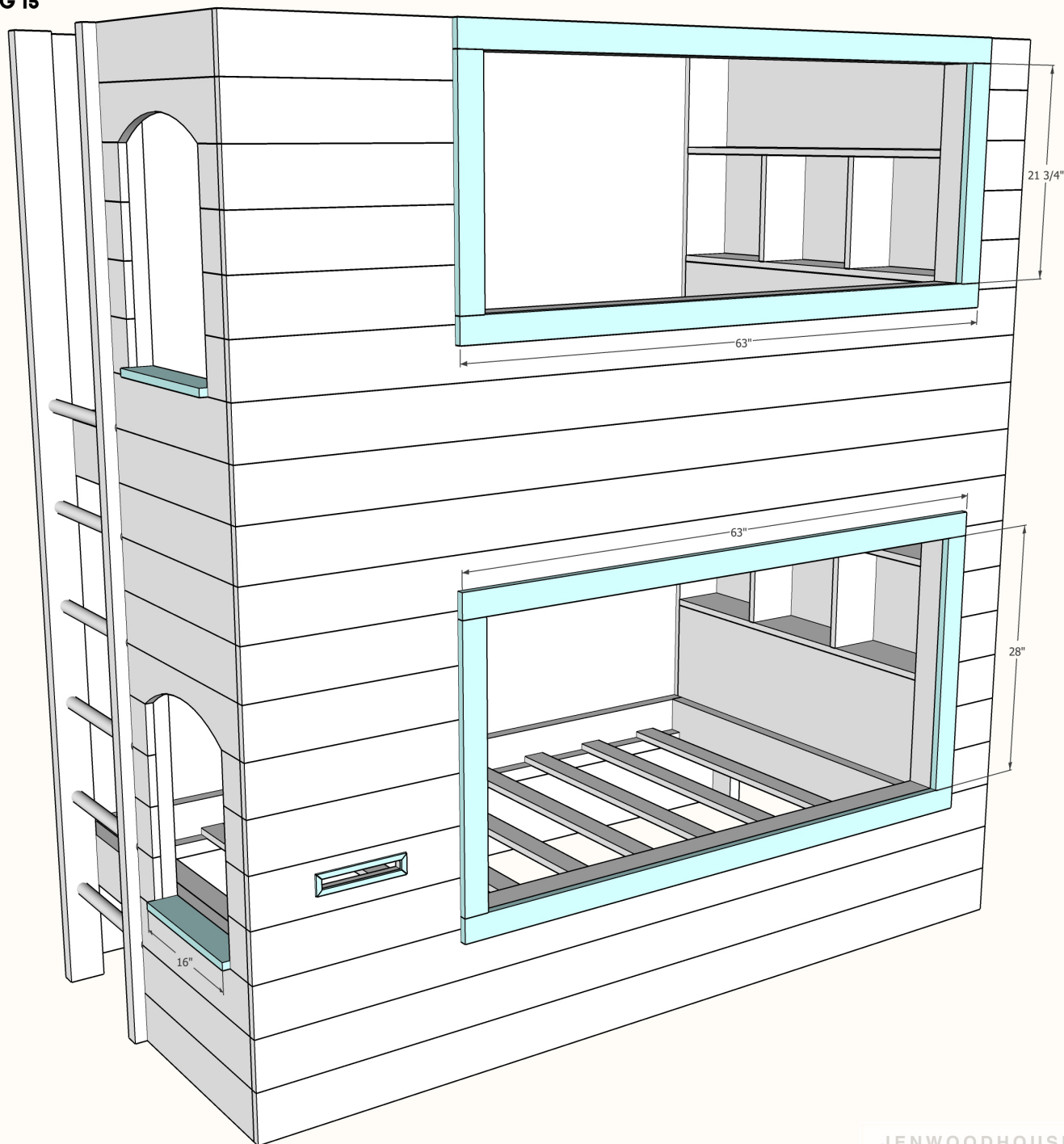
**STEP 15:**

Measure, mark, and rip-cut 1x4 window trim boards and window ledges to 3 inches wide. Cross-cut the boards to length. Attach them to the bunk bed with 1 1/4-inch brad nails. Optional: add trim around the mail slot.

For more information, visit JenWoodhouse.com to read the blog post and watch the video!